

# PAJERO / MONTERO LUGGAGE FLOOR HOOK MZ521640EX INSTALLATION AND HANDLING INSTRUCTIONS

When installed to rear bench seat:  
(Short-body model is shown.)

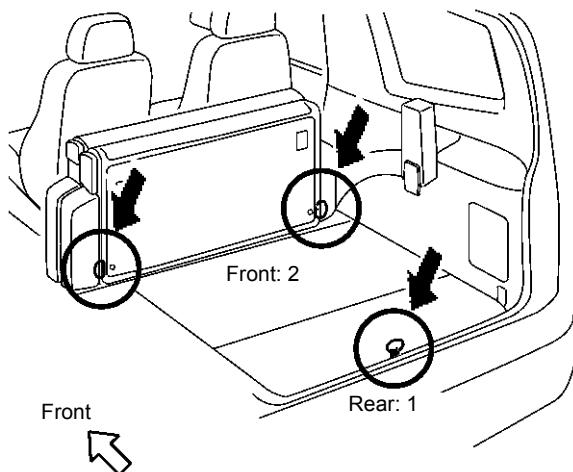

When installed to rear split seat:  
(Long-body model is shown)

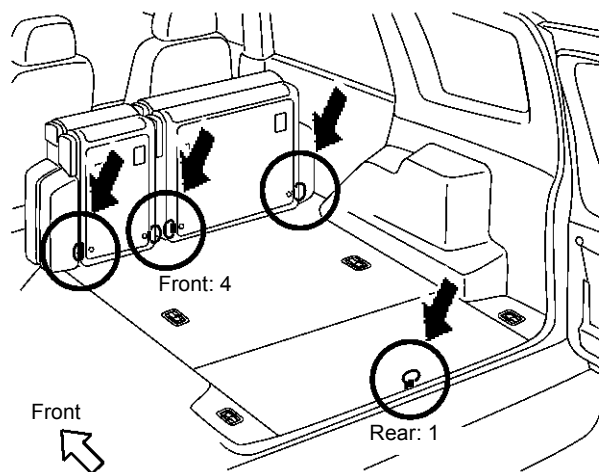

Thank you for purchasing the Mitsubishi Genuine Accessory.  
To install and use the product correctly with proper knowledge of it, read this publication carefully.  
Keep this publication for reference when maintenance is required.

## Attention

- This publication gives precautionary instructions in the boxes titled as follows.  
Read through these instructions thoroughly.



### Caution

Describes precautions that should be observed in order to prevent injury or damage to the vehicle or its components, which may occur if sufficient care is not taken.



### Note

Provides additional information that facilitates installation work.

- Failure to follow these instructions not only prevents the product from working properly but may lead to trouble with the vehicle. Be sure to follow all instructions carefully.
- If there is anything unclear about the installation, handling and/or usage of the product, contact your Mitsubishi Motors dealer for clarification.
- Mitsubishi Motors Corporation is not responsible for any defects or difficulties caused by or resulting from the failure to follow given instructions.
- We recommend you to have the installation performed at an authorized Mitsubishi Motors dealer.

To the dealer:

Be sure that the customer receives this publication.

## ■ TOOLS (Make the following tools ready for use.)

Phillips screwdriver

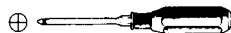

Trim remover



## ■ COMPONENTS (Make sure that all of the following components were included in the kit.)

① Front hook: 4



If the hooks are installed to the rear bench seat, 2 of 4 are used.

② Rear hook: 1

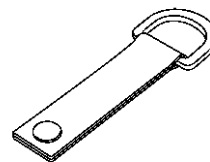

## ■ PRECAUTIONS

- Be sure to apply the parking brake securely. Remove the ignition key from its key cylinder.

## INSTALLATION PROCEDURES

### A. PREPARATORY WORK

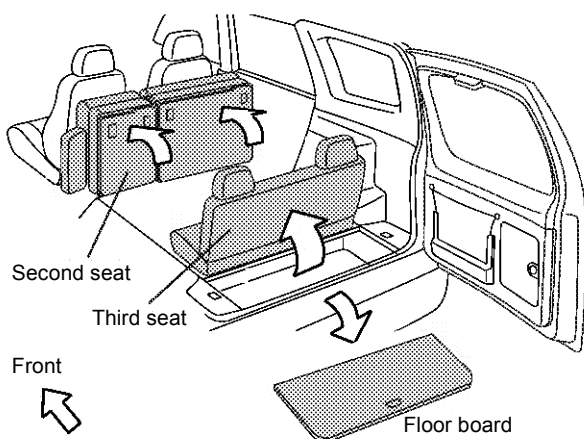

- 1) Fold and tumble the second seat.
- 2) Remove the floor board.
- 3) On long-body models, take out the third seat from the luggage floor box.

Check

## B. INSTALLING THE FRONT HOOKS

- 1) From the second seat, remove the screws shown in the drawing, install the front hooks ① to that position and then reinstall the screws.  
(Two hooks can be installed on the bench seat and four hooks can be installed on the split type seat.)

On bench seat

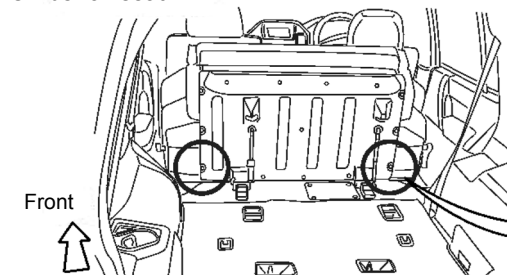

On split seat

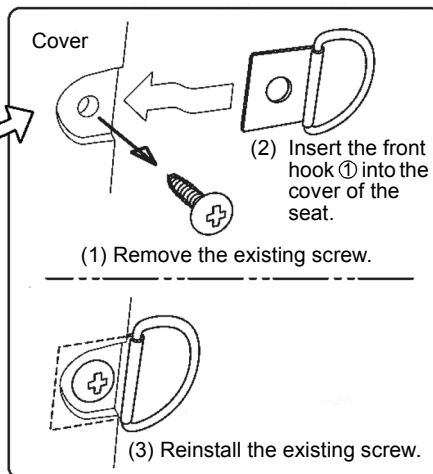
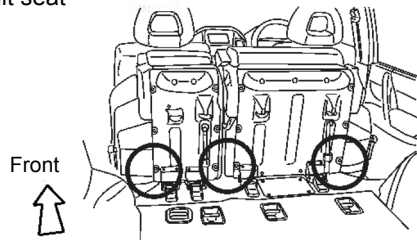

Check	
-------	--

## C. INSTALLING THE REAR HOOK

- 1) Remove the center clip in the luggage floor box shown in the drawing.
- 2) Fit the rear hook ② to the plastic hook from where the center clip has been removed.

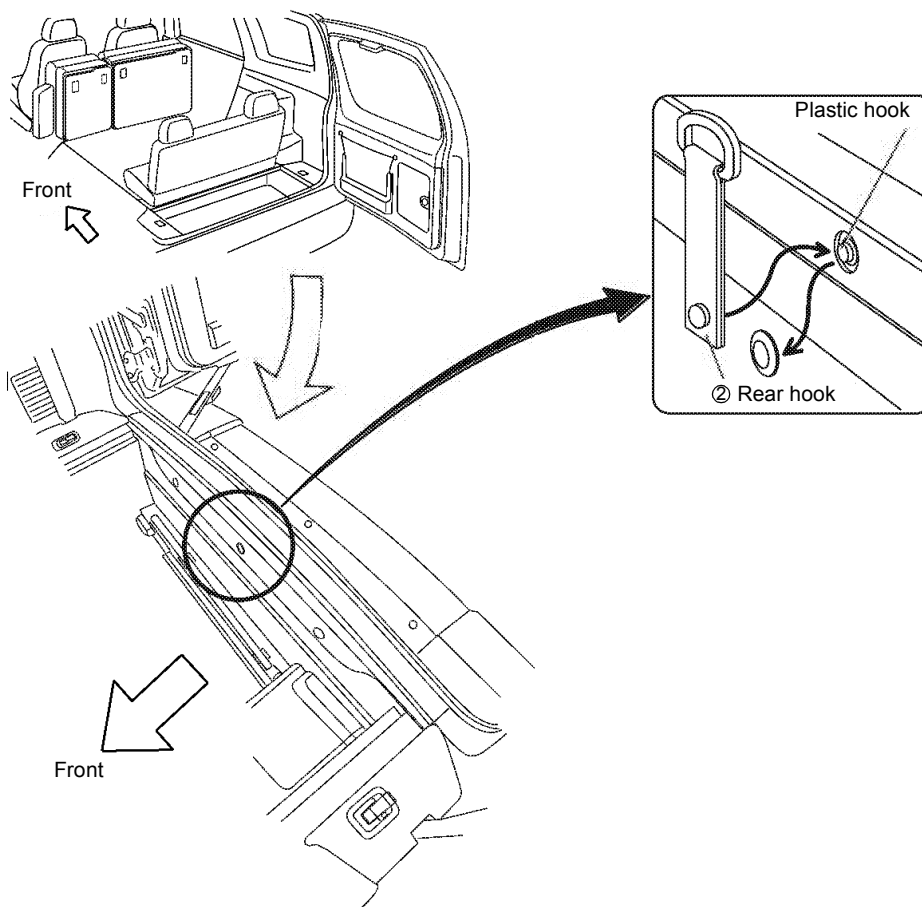

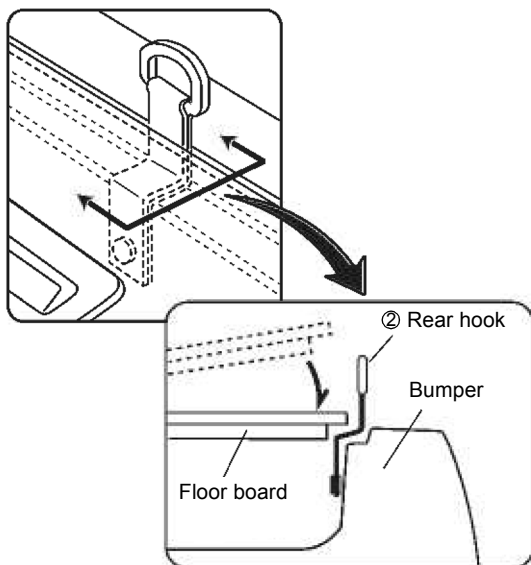

- 3) Reinstall the floor board while pulling out the rear hook ②.

Check

## CARE AND HANDLING



### Caution

Maximum load for each hook is 5 kg.

You can use the luggage space in many ways using these hooks in combination with the separately-sold Mesh net (MZ521705), Luggage floor net (MZ521638), etc.  
(Drawings show examples of the use with Mesh net.)

Both sides of the split seat tumbled

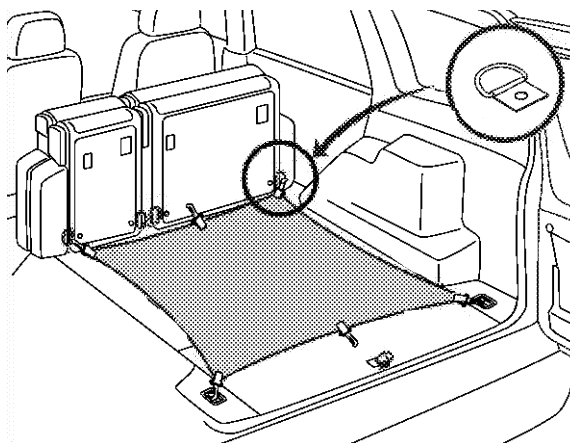

Only one side of the split seat tumbled

