

PAJERO / MONTERO
AUTOMATIC TRANSMISSION SHIFT KNOB
MZ527510EX (Wood)
MZ527511EX (Leather)
INSTALLATION AND HANDLING INSTRUCTIONS

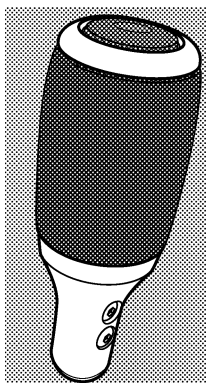

Thank you for purchasing the Mitsubishi Genuine Accessory.
To install and use the product correctly with proper knowledge of it, read this publication carefully.
Keep this publication for reference when maintenance is required.

Attention

- This publication gives precautionary instructions in the boxes titled as follows.
Read through these instructions thoroughly.



Caution

Describes precautions that should be observed in order to prevent injury or damage to the vehicle or its components, which may occur if sufficient care is not taken.



Note

Provides additional information that facilitates installation work.

- Failure to follow these instructions not only prevents the product from working properly but may lead to trouble with the vehicle. Be sure to follow all instructions carefully.
- If there is anything unclear about the installation, handling and/or usage of the product, contact your Mitsubishi Motors dealer for clarification.
- Mitsubishi Motors Corporation is not responsible for any defects or difficulties caused by or resulting from the failure to follow given instructions.
- We recommend you to have the installation performed at an authorized Mitsubishi Motors dealer.

To the dealer:
Be sure that the customer receives this publication.

■ TOOLS (Make the following tools ready for use.)

Phillips screwdriver

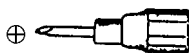

■ COMPONENTS (Make sure that all of the following components were included in the kit.)

① Shift knob: 1

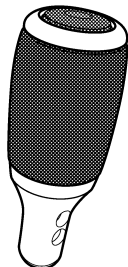

② Hexagon socket head screw: 4



③ Spring washer: 4



④ Key wrench (2.5 mm): 1



■ PRECAUTIONS

- Be sure to apply the parking brake securely. Remove the ignition key from its key cylinder.
- Set the shift lever in the “P” (parking) position.

INSTALLATION PROCEDURES

A. REMOVING THE STANDARD SHIFT KNOB

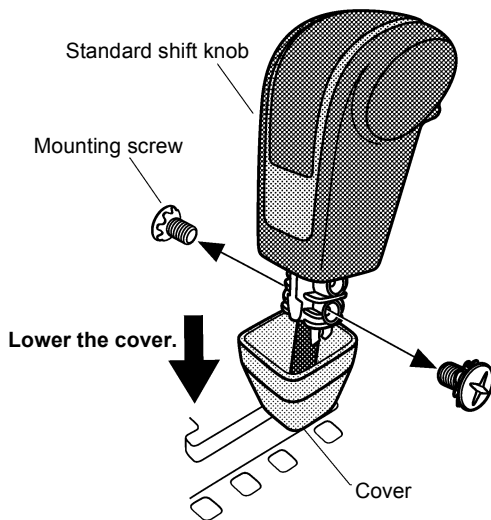

- 1) Pull down the lower cover of the standard shift knob and remove four mounting screws.
- 2) Pull and remove the standard shift knob. If the sleeve is removed together with the shift knob, return it to the shift rod.

Check	
-------	--

B. INSTALLING THE NEW SHIFT KNOB

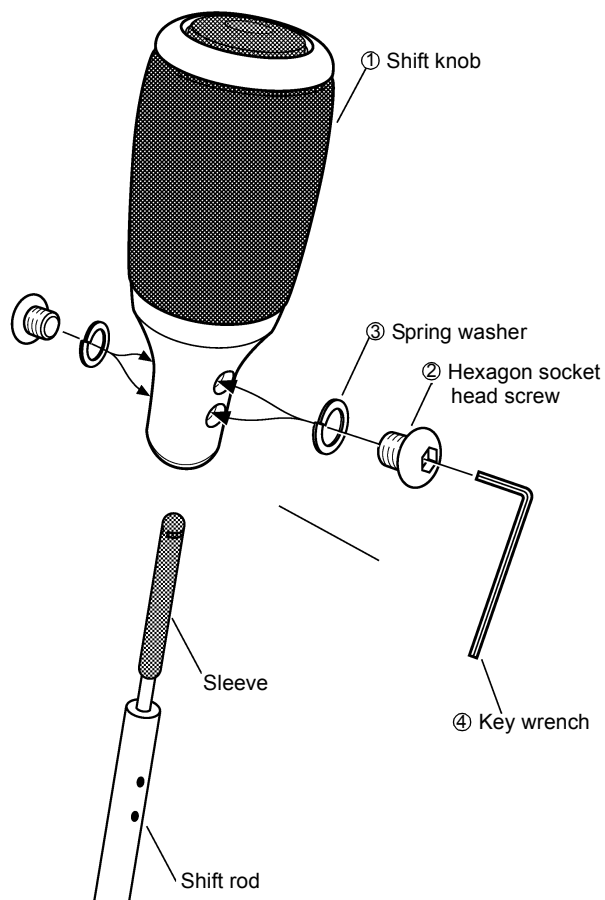

- 1) With its seam facing forward, put the shift knob ① over the shift rod and secure it with four hexagon socket head screws ② and spring washers ③.

Check	
-------	--

C. CHECKING AFTER INSTALLATION

- Make sure that there is no looseness on the product.
- Check if the shift lever functions properly.

Check	
-------	--

REINSTALLATION OF STANDARD SHIFT KNOB

- 1) Remove the A/T shift knob ① by following the step **B** in reverse order.
- 2) Install the standard shift knob by following the step **A** in reverse order.

CARE AND HANDLING



Caution

The metal parts of the product may become hot when the cabin is hot.

- Before driving, check that the product is fitted securely.
- Whenever anything wrong is found with the product, contact an authorized Mitsubishi Motors dealer.
- To clean the product, wipe with a dry and clean soft cloth. Do not use any solvent or abrasive.