

BIKE ATTACHMENT

INSTALLATION AND HANDLING INSTRUCTIONS

Thank you for purchasing the Mitsubishi Genuine Accessory.
To install and use the product correctly with proper knowledge of it, read this publication carefully.
Keep this publication for reference when maintenance is required.

Attention

- This publication gives precautionary instructions in the boxes titled as follows.
Read through these instructions thoroughly.



Warning

Describes precautions that should be observed in order to prevent serious injury or death to the user.



Caution

Describes precautions that should be observed in order to prevent injury or damage to the vehicle or its components, which may occur if sufficient care is not taken.



Note

Provides additional information that facilitates installation work.

- Failure to follow these instructions not only prevents the product from working properly but may lead to trouble with the vehicle. Be sure to follow all instructions carefully.
- If there is anything unclear about the installation, handling and/or usage of the product, contact your Mitsubishi Motors dealer for clarification.
- Mitsubishi Motors Corporation is not responsible for any defects or difficulties caused by or resulting from the failure to follow given instructions.
- We recommend you to have the installation performed at an authorized Mitsubishi Motors dealer.

Part No.: MZ532211EX

Product name: BIKE ATTACHMENT (Upright Loading)

Applicable model: VEHICLES EQUIPPED WITH BASE CARRIER

To the dealer:
Be sure that the customer receives this publication.

I. INSTALLATION INSTRUCTIONS

When you complete each step of the installation process, be sure to tick the relevant Check box.

1 Completed Assembly Drawing

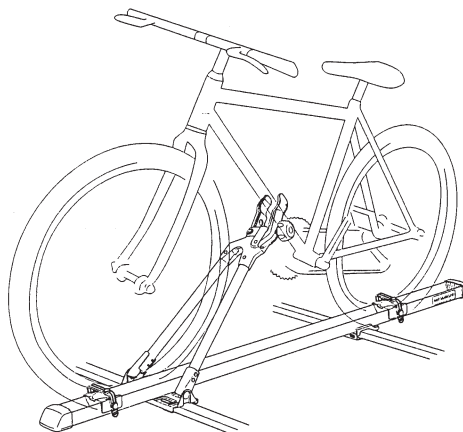

Warning

Be sure to check that the base carrier on which the bike attachment will be installed is in order in accordance with "Checking after Installation" in the Installation and Handling Instructions for Base Carrier.



Note

The logo sticker ③ may be attached at a desired position.

2 Tools (Make the following tools ready for use.)

Phillips screwdriver

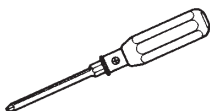

Tape measure



Shop towel



Check

3 Components (Check the kit for missing, stained, scratched and otherwise damaged parts.)

No.	Part Name	Quantity	No.	Part Name	Quantity
①	Bike attachment	1	④	Spacer plate (small)*	1
②	Rubber band	2	⑤	Spacer plate (large)*	1
③	Logo sticker	2			

*: The spacer plate (small) ④ and the spacer plate (large) ⑤ are required when installing this bike attachment to the following base carriers:

MZ532140
MZ532141
MZ532148EX
MZ532149EX

①

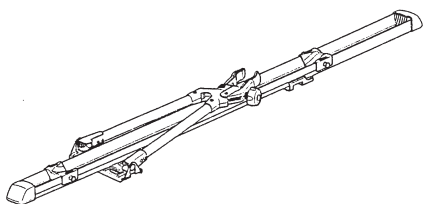

②



③



④



⑤



Check

4 Assembling



Caution

- The attachment is installed on the base carrier after assembled. Carry out the assembly in the exact sequence described below.
- Handle the product taking care not to drop or damage it.

1. Securing Mounting Stay

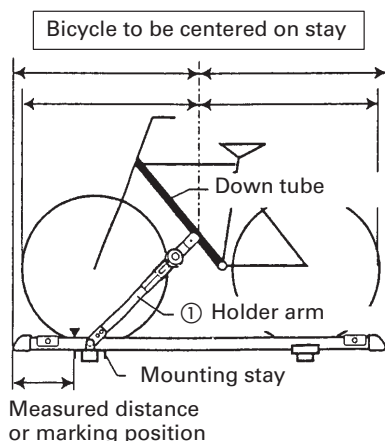
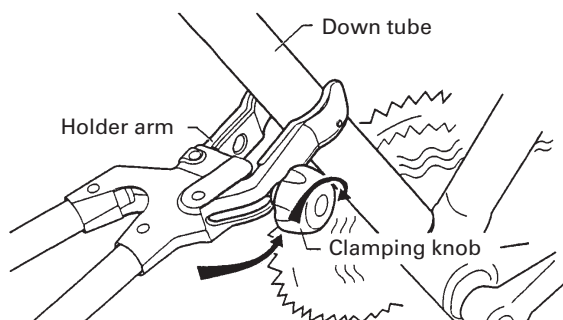
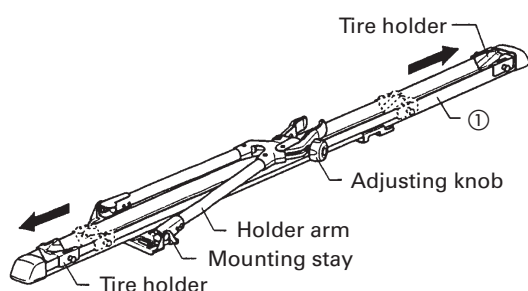
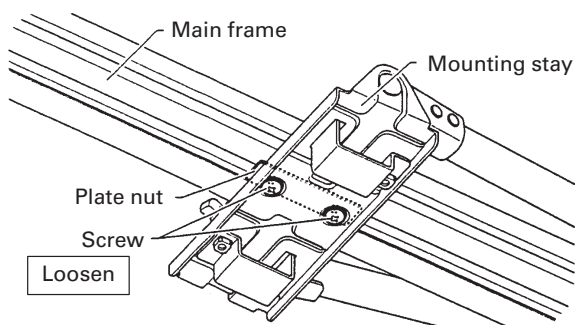

1) Loosen the screws securing the mounting stay to the bike attachment ①.

2) Loosen the adjusting knob to release the holder arm.

3) Slide the tire holders toward front and rear ends, respectively. Place the bike attachment ① on the ground.

4) Set a bicycle on the main frame of the bike attachment ①. Adjust the mounting stay position and hold the bicycle by clamping the down tube with the holder arm.



Note

For how to use the holder arm, refer to "2. Loading a bicycle" and "3. Securing bicycle" on P. 6.

5) Determine the position of the mounting stay where the bicycle is centered on the main frame of the bike attachment ① and mark the position.

6) Remove the bicycle from the bike attachment ①. Set the mounting stay accurately to the marking position and tighten the screws having loosened in Step 1) to secure the stay.

Tightening torque (reference):
3.0 N · m (0.3 kgf.m)

Check

5 Installation Procedures



Caution

- Before installing the attachment, wipe off dirt, dust, etc. from the supporting bars and other areas of the base carrier. Use care not to scratch or otherwise damage the vehicle body during installation.
- Carry out the installation work in a spacious place free from any obstacles that prevent the doors from being opened and closed properly.

1. Removing fasteners and fixture (A)

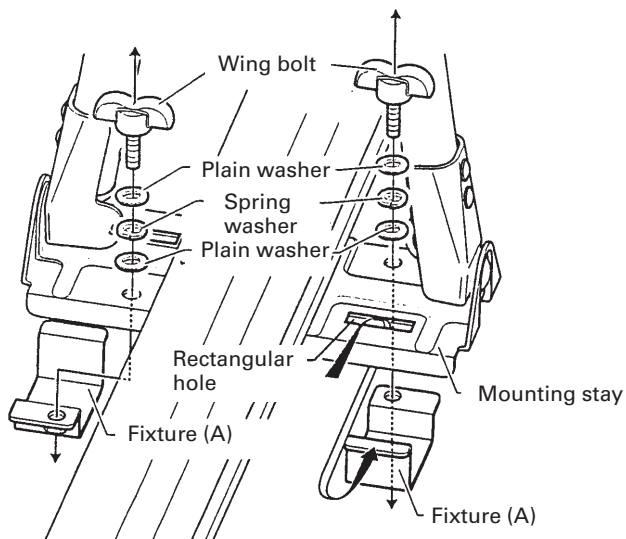

Note

Use care not to lose removed parts.

- 1) Remove the wing bolts, plain washers, spring washers and fixtures (A) from the mounting stay of the bike attachment ①. (2 places)

Check

2. Removing clamping knob and fixture (B)

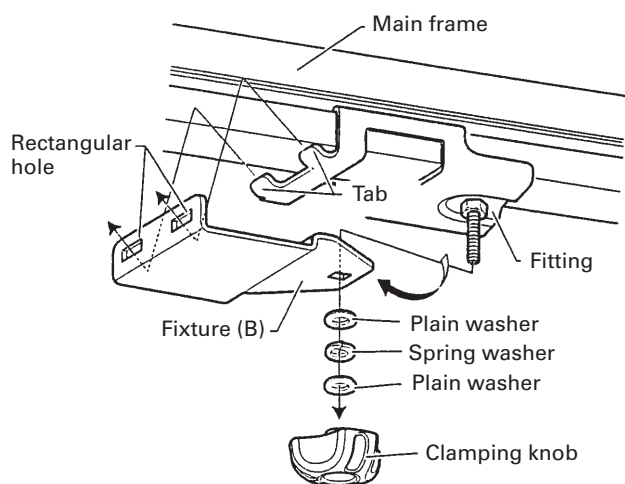

Note

Use care not to lose removed parts.

- 1) Remove the clamping knob, plain washers, spring washer and fixture (B) from the fitting of the bike attachment ①. (1 place)

Check



Note

When installing the bike attachment to the base carriers listed below, attach the spacer plates ④ and ⑤ to the fixtures (A) and (B) respectively.

MZ532140

MZ532141

MZ532148EX

MZ532149EX

3. Attaching spacer plate to fixture (A)

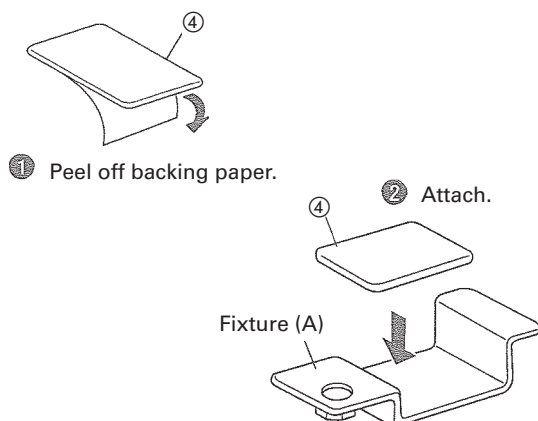

- 1) Peel off the backing paper from the spacer plate (small) ④ and attach the plate ④ to the fixture (A). (2 pieces)

Check

4. Attaching spacer plate to fixture (B)

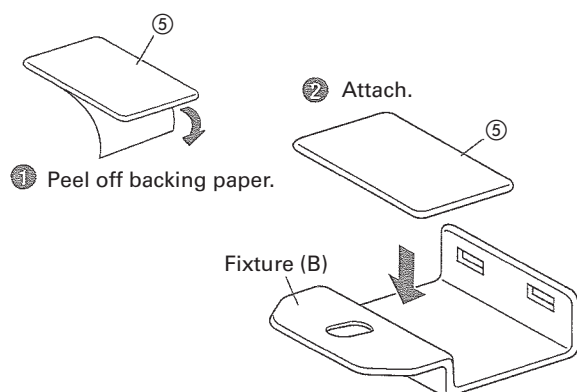

- 1) Peel off the backing paper from the spacer plate (large) ⑤ and attach the plate ⑤ to the fixture (B).

Check

5. Securing Front Fixture

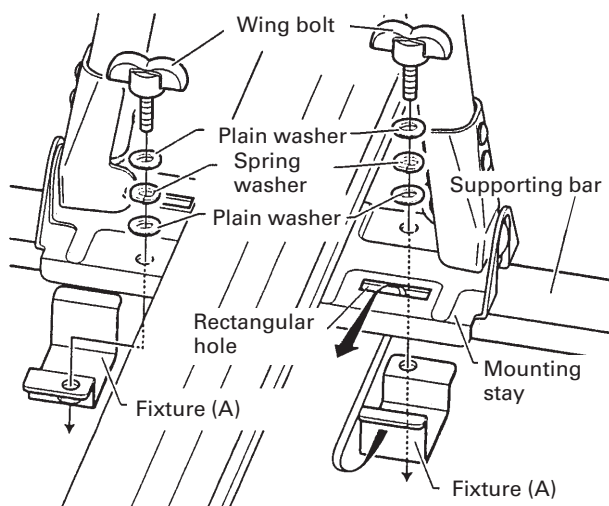

- 1) Place the bike attachment ① on the base carrier supporting bars of the vehicle.
- 2) Fit the end having no hole of the fixture (A) into the rectangular hole in the mounting stay of the bike attachment ① and secure the other end with plain washer, spring washer and wing bolt. (2 places)

Tightening torque (reference):
 $3.0 \text{ N} \cdot \text{m}$ (0.3 kgf.m)

Check

6. Securing Rear Fixture

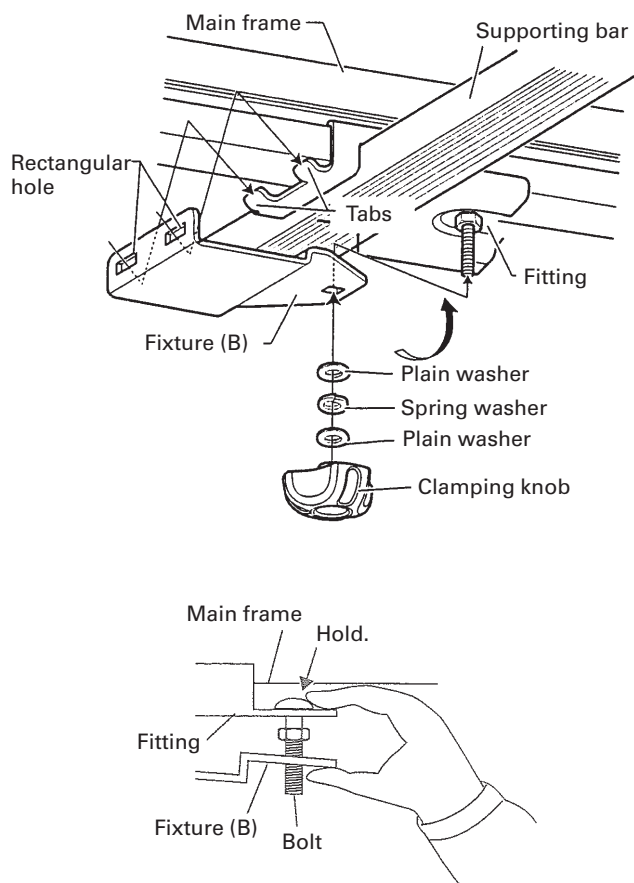

- 1) Fit the tabs of the fitting of the bike attachment ① in the rectangular holes of the fixture (B) and, while holding the bolt of the fitting with a finger, tighten the other end with plain washers, spring washer and clamping knob. (1 place)

Tightening torque (reference):
3.0 N·m (0.3 kgf.m)

Check

6 Loading Procedure



Caution

- When loading a bicycle on the attachment, be careful not to scratch or otherwise damage the vehicle.
- If the bicycle is fitted with accessories, remove them before loading.

1. Preparation for Loading a Bicycle

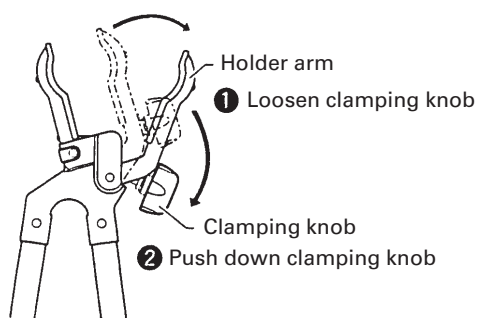

- 1) Perform the procedures ① and ② shown in the illustration at left to open the holder arm of the bike attachment ①.



Note

Moving the clamping knob up and down helps to open and close the holder arm rapidly.

Check

2. Loading a Bicycle

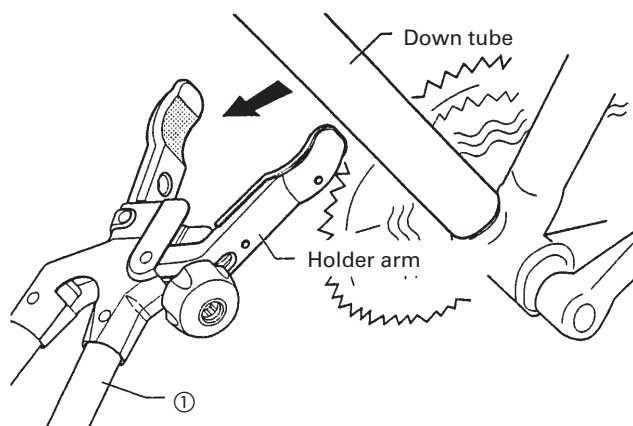

- 1) Place the bicycle on the main frame of the bike attachment ①.
- 2) Move the bicycle to the position where the down tube of the bicycle can be held in the holder arm (shaded portion in the illustration).

Check	
-------	--

3. Securing Bicycle

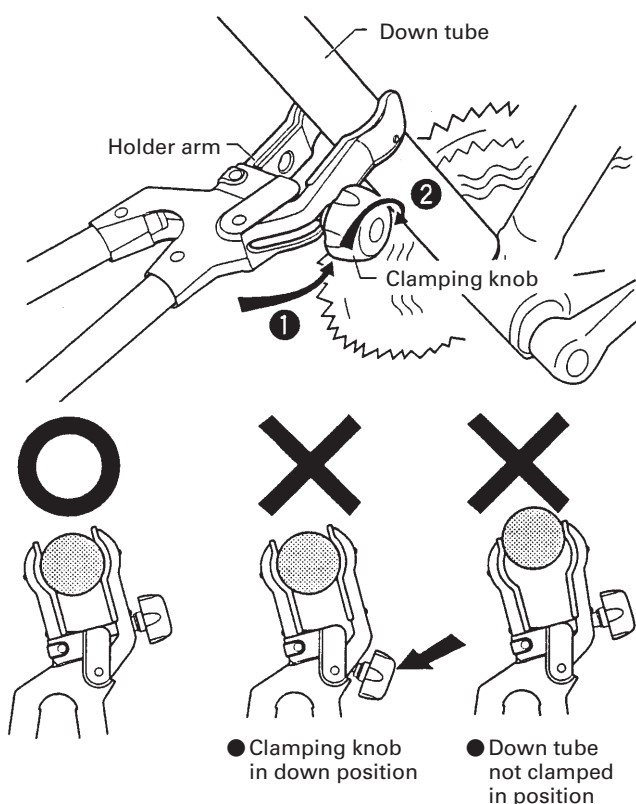

Warning

If the down tube is not held correctly in the holder arm, the bicycle may shift out of position and fall down from the roof during driving, which can cause a very dangerous situation. Be sure to check that it is held securely in position after loading.

- 1) Slide the clamping knob upward to clamp the down tube in the holder arm of the bike attachment ①.
- 2) After confirming that the bicycle is centered on the main frame of the bike attachment ①, tighten the clamping knob fully to secure the bicycle firmly.

Check	
-------	--

4. Securing Tires

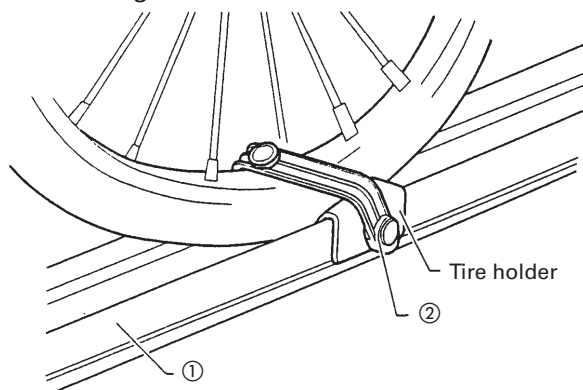

- 1) Slide the front and rear tire holders of the bike attachment ① until they come into contact with the respective tires.
- 2) Fasten the rubber band ② to the projections of each tire holder to secure the front and rear tires.

Check	
-------	--



Note

When installing two attachments, install them in the following manner and set bicycles on them as illustrated below.

1. Arrangement of bicycle(s)

Loading one bicycle

Loading two bicycles

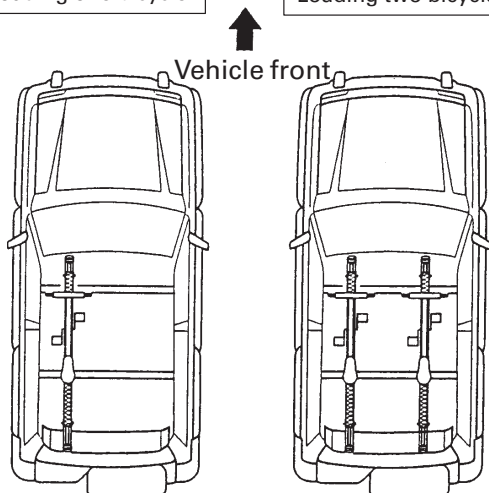

1) When loading one bicycle:

- Set the attachment at the left side of the vehicle as shown in the illustration.

2) When loading two bicycles:

- Mount the bicycles facing in the same direction.

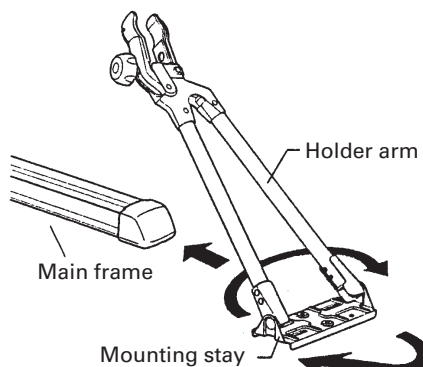

Mounting stay to be reversed

Check



Note

When loading two bicycles in the same direction (forward), reverse the direction of the holder arm of the attachment installed on the right side so that the clamping knob is located outward. By doing so, the clamping work of the bicycle will be facilitated.

When handle bars or pedals of two bicycles interfere with each other

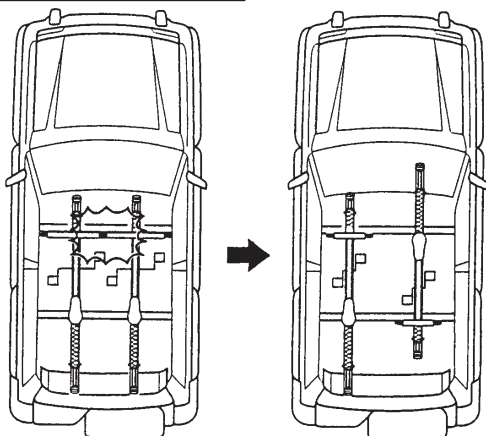

- If handle bars or pedals may interfere with each other, install the attachments in the opposite direction.

Check

7 Checking after Installation



Caution

- 1) Check that the installation has been done correctly with all the fasteners securely tightened.
- 2) Check that all the parts are positioned as specified.
- 3) Shake each attachment lightly to ascertain that it is steady.
- 4) If above checks 1) to 3) revealed poor installation, repeat the installation process from the beginning.

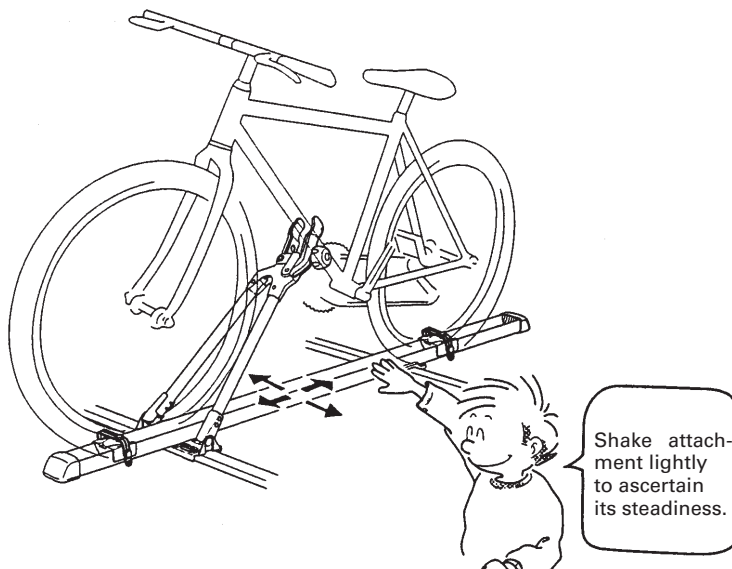

Caution

When the attachment is not used, always secure the holder arm with the tire holder and the rubber band ② to prevent it from rattling.

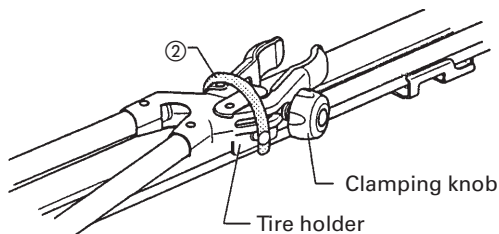

Check	
-------	--

After the installation work is completed, check to see if the Check boxes have been all ticked.

8 Removal



Caution

- Be careful not to lose removed parts.
- To ensure safety and efficiency as well, we recommend that removal be performed by two persons.
- When removing the attachment, take care not to scratch or otherwise damage the vehicle body and base carrier.

1. Unfastening Front Fixture

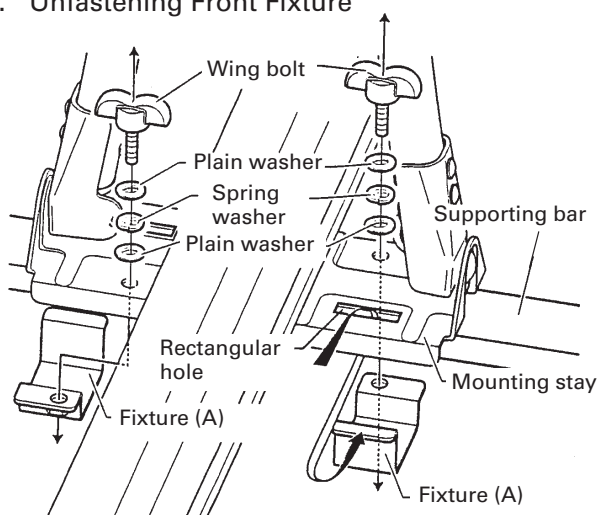

- 1) Unload the bicycle from the attachment.
- 2) Remove the wing nut, plain washers and spring washer. Then, remove the fixture (A) from the mounting stay of the bike attachment ① by pulling out its end from the rectangular hole in the stay. (2 places)

2. Unfastening Rear Fixture

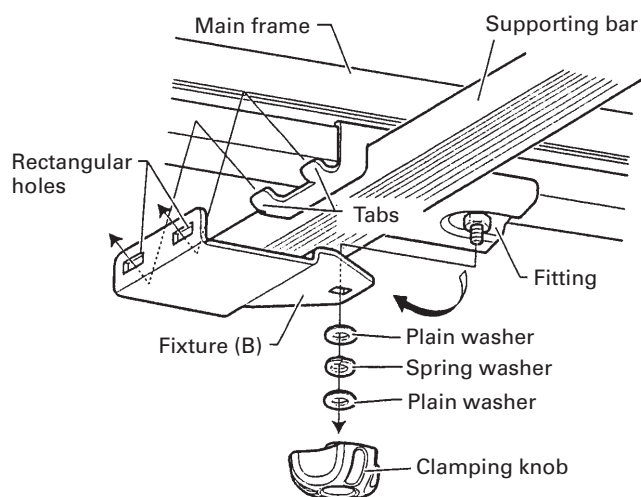

- 3) Remove the clamping knob, plain washers and spring washer, then remove the fixture (B) from the fitting. (1 place)
- 4) Dismount the bike attachment ① from the supporting bar.

Check	
-------	--

II. CARE AND HANDLING

Read the following instructions carefully and follow them to ensure correct use of the product.

■ Handling Precautions

- (1) Before and after driving
 - The maximum load is 15 kg per attachment. Do not overload.
 - The attachment cannot be used for loading a bicycle with special frame configuration. It cannot also be used for a bicycle having a down tube with oval or square sectional form or larger than 55 mm in diameter.
 - New fasteners need some time to be broken in. Check for their looseness with particular care and retighten for a while after installation. After the vehicle does 100 km or so, check that bolts, clamps, etc. are all tight and secure.
 - If the bicycle is fitted with accessories, remove them before loading.
 - The fasteners of the base carrier and/or attachment may become loose during running on rough roads. Before and after driving, be sure to check bolts, knobs, etc. for looseness and retighten if necessary.
 - Determine the right position of the bicycle on the attachment rail in such a way that the bicycle may be secured by the frame clamp without any undue force being exerted to the pedals and chain sprocket.
 - When opening the trunk lid or tail gate, be careful not let it strike against the bicycle.
- (2) During driving
 - With a bicycle carried on the roof, drive the vehicle carefully and avoid steering sharply and accelerating and braking rapidly. Keep your speed down when running on sharp curves, rough roads and in strong side or head winds as control over the vehicle can be greatly impaired under such conditions.
 - With a carrier attached on the roof, make sure of sufficient overhead clearance before entering a tunnel or roofed parking space.
 - Be careful when operating the sunroof (tilt up and slide) with the carrier attached. Loaded bicycle may interfere with the sunroof glass and damage it.
- (3) When washing the vehicle
 - Avoid washing the vehicle in an automatic car washer when it is fitted with the base carrier. Detachment of the base carrier and/or attachment, deformation of the roof and other problems could occur.

■ Maintenance

- If the paint or coating on the carrier becomes scratched, cover the scratch with touch-up paint to prevent rust.
- Move the nuts, bolts and knobs occasionally. If they are left untouched for a long period, they may become stuck.
- If the carrier becomes dirty, wipe it clean using a soft cloth or sponge moistened with a mild detergent. Do not use leather wax, tire wax or organic solvent such as paint thinner.

■ Reinstallation

- Before reinstallation, make sure that all the parts are available and damage-free. Then, carry out the work in accordance with instructions given in this publication.
- Should any part be found damaged or missing, contact an authorized Mitsubishi Motors dealer.