

AIRTREK/OUTLANDER DOOR MIRROR COVER MZ576010EX

INSTALLATION AND HANDLING INSTRUCTIONS

Thank you for purchasing the Mitsubishi Genuine Accessory.
To install and use the product correctly with proper knowledge of it, read this publication carefully.
Keep this publication for reference when maintenance is required.

Attention

- This publication gives precautionary instructions in the boxes titled as follows.
Read through these instructions thoroughly.



Caution

Describes precautions that should be observed in order to prevent injury or damage to the vehicle or its components, which may occur if sufficient care is not taken.



Note

Provides additional information that facilitates installation work.

- Failure to follow these instructions not only prevents the product from working properly but may lead to trouble with the vehicle. Be sure to follow all instructions carefully.
- If there is anything unclear about the installation, handling and/or usage of the product, contact your Mitsubishi Motors dealer for clarification.
- Mitsubishi Motors Corporation is not responsible for any defects or difficulties caused by or resulting from the failure to follow given instructions.
- We recommend you to have the installation performed at an authorized Mitsubishi Motors dealer.

To the dealer:
Be sure that the customer receives this publication.

■ TOOLS (Make the following tools ready for use.)

Standard screwdriver (medium)



Trim remover
(MB990784)



Protective tape



■ COMPONENTS (Make sure that all of the following components were included in the kit.)

① Door mirror cover: 2 (left and right, 1 each)

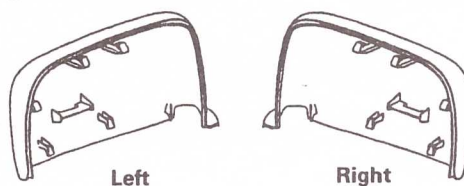

■ PRECAUTIONS

- The illustrations in the Installation Procedures depict the installation on the left side. Perform the same procedure also on the right side.

INSTALLATION PROCEDURES

A. PREPARING FOR HOLDER MIRROR REMOVAL

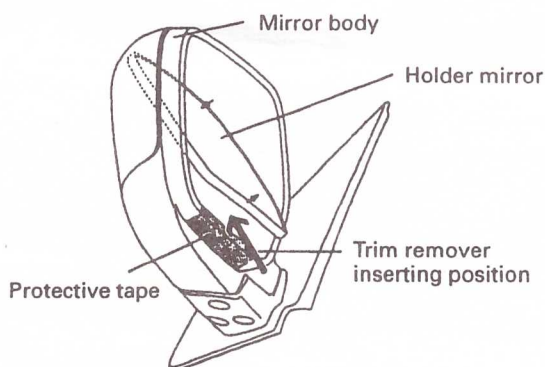

- 1) Apply protective tape to the mirror body.
- 2) Push the mirror top to turn the mirror surface upward.
- 3) Insert the trim remover (as shown in the illustration at left), and ascertain the screwdriver inserting position from between the mirror body and holder mirror.



Caution

Do not pry open the holder mirror by inserting the trim remover forcibly. Holder mirror tabs could be broken.



Note

It is dark inside the bezel. Using a flashlight, ascertain the screwdriver inserting position.

Check

B. REMOVING HOLDER MIRROR

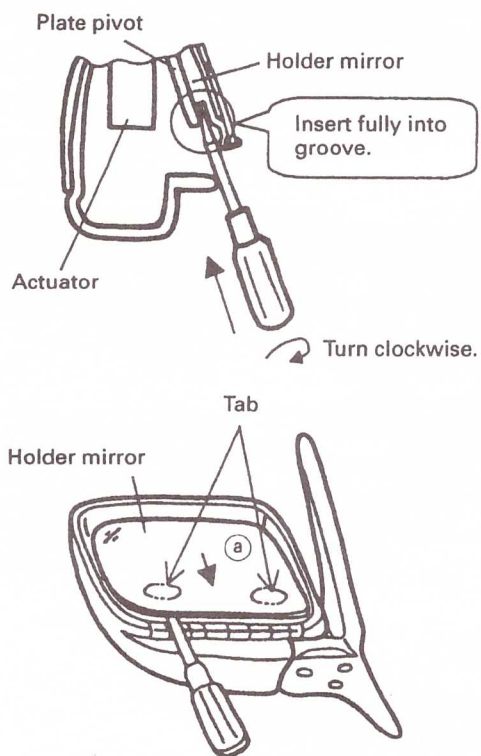

- 1) Insert a standard screwdriver in the groove between holder mirror and plate pivot (in the position ascertained at A) as shown in the illustration at left.
- 2) Turning the screwdriver clockwise, unfasten two holder mirror tabs, one by one. (Unfastening by force could break the tabs.)
- 3) Push the lower side of the plate pivot to turn the mirror downward, then pull out the holder mirror in the direction of arrow (a). (Pulling out by force could damage the actuator.)



Caution

- When removing the holder mirror, take care not to break its tabs. If used with broken tabs, the holder mirror may fall off.
- Holder mirror tabs are made of plastic. When it is cold, carry out work while warming tabs and around (to at least 20°C) with a dryer.
- In the case of heated door mirror, disconnect heater harness connector from the connector of the backside of the holder mirror before removal.

Check

C. REMOVING MIRROR COVER

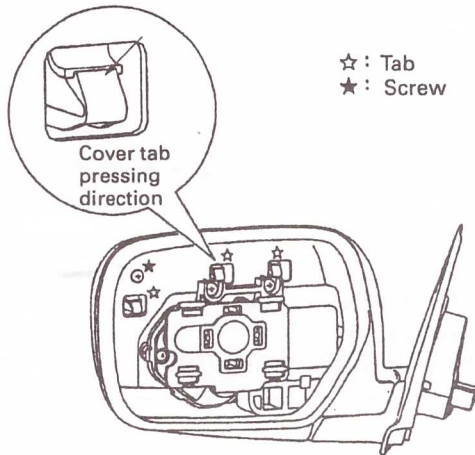

- 1) Remove screw (1 place).
- 2) Unfasten tabs (3 places) and remove the mirror cover.

Caution

- Removed screw will be reused. Do not lose it.
- When removing the mirror cover, take care not to break tabs. If any of the tabs is broken, be sure to remove it. Broken tab causes an abnormal sound.

Check

D. INSTALLING DOOR MIRROR COVER

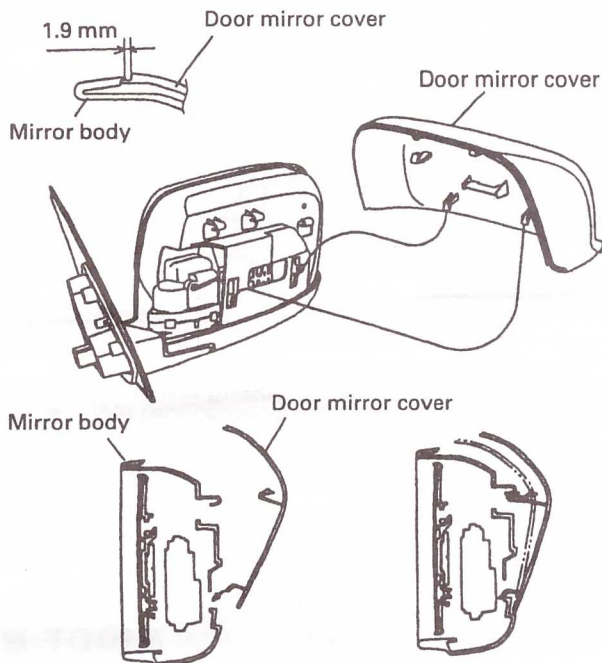

- 1) Hook two lower tabs of the door mirror cover in the mating holes in the mirror body.
- 2) Holding the top part of the door mirror cover, fit other three tabs in the mirror body.
- 3) Reinstall the screw (1 place) removed at **C** and tighten it to secure the door mirror cover in place.

Note

Install the door mirror cover to be even clearance between it and the mirror body.

Check

E. INSTALLING HOLDER MIRROR

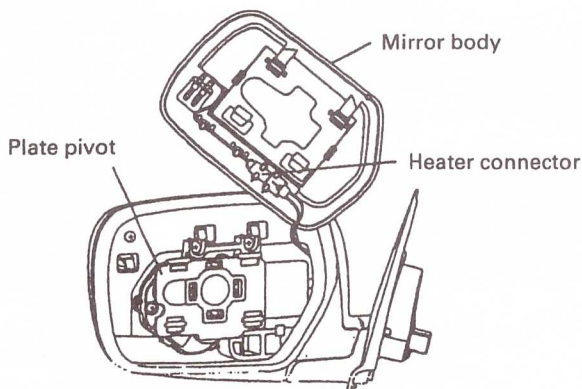

- 1) Set the plate pivot in place facing downward while holding its lower part.

Caution

In the case of heated door mirror, connect heater harness to the connector of the backside of the holder mirror before fitting the holder mirror in plate pivot holes.

Check

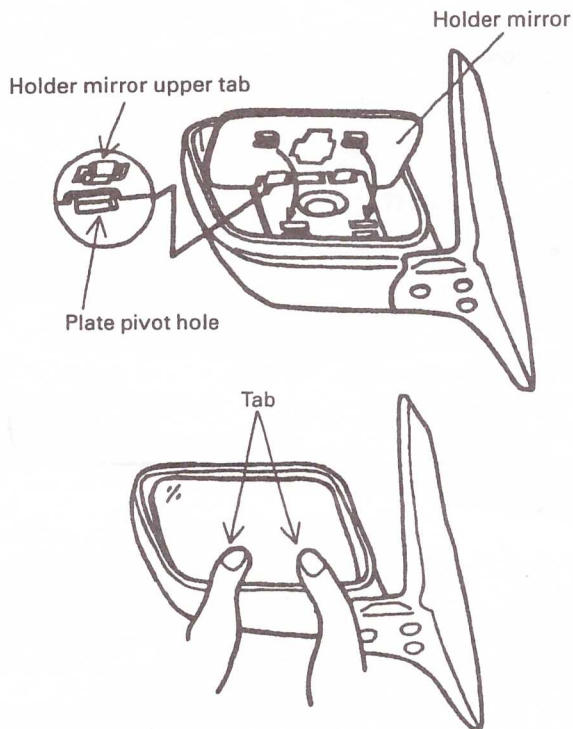

- 2) Fit upper tabs on the backside of the holder mirror in appropriate plate pivot holes.
- 3) Set the holder mirror in place onto the actuator.
- 4) Turn the holder mirror and plate pivot downward, then press the holder mirror to fit its two other tabs firmly into the mating holes as shown.



Caution

When fitting holder mirror lower tabs in the mating holes, press the holder mirror in the areas near the tabs. Pushing elsewhere could break the mirror.

- 5) Make sure that the holder mirror is installed in place and all the tabs are firmly fitted in the mating holes.

Check	
-------	--

CARE AND HANDLING

- Use a soft material such as sponge or chamois.
- Do not clean with any hard material that could scratch the surface, such as a scrubbing brush.
- Do not use polishing powder-compounded wax. The plastic surface could be scratched.
- Never use gasoline, kerosene, brake fluid, engine oil, grease, paint thinner, sulfuric acid (battery fluid) and wax remover that cause the surface to be discolored, stained or cracked. Should any of them contact the surface, wipe it off with a soft cloth moistened with a neutral detergent solution or chamois leather, then flush the surface with sufficient water immediately.