

GROUP 00

GENERAL

CONTENTS

| | | | |
|-------------------------------------|-------------|-----------------------------|-------------|
| VEHICLE IDENTIFICATION | 00-2 | GENERAL DATA AND | |
| MODELS..... | 00-2 | SPECIFICATIONS | 00-5 |
| VEHICLE IDENTIFICATION NUMBER | | GENERAL DATA AND | |
| (CHASSIS NUMBER) | 00-3 | SPECIFICATIONS..... | 00-5 |
| CERTIFICATION LABEL | 00-4 | | |

VEHICLE IDENTIFICATION

MODELS

M1001000307773

| Model code | | Engine model | Transmission model | Fuel system |
|------------|---------|---|--------------------------------|--|
| KH4W | GNMZLAZ | 4D56 (2,477 mL) DOHC DI-D (Direct Injection-Diesel) | V5MB1 (Super select 4WD, 5M/T) | Common rail fuel injection (Electrical fuel injection) |
| | GYPZLAZ | high-power engine with intercooled turbocharger | V5A5A (Super select 4WD, 5A/T) | |
| | GYUZLAZ | | | |
| | GYMZLAZ | | | |
| KH6W | GYPYLAZ | 6B31 (2,998 mL) SOHC MIVEC petrol engine | | MPI |
| | GYUYLAZ | | | |
| | GYMYLAZ | | | |

MODEL CODE

K H 4 W G Y P Z L A Z

1 2 3 4 5 6 7 8 9 10

ACD01887AB

| No. | Item | Content | |
|-----|--------------------------|---------|--|
| 1 | Development | K | PAJERO SPORT |
| 2 | Drive system | H | 4WD |
| 3 | Engine | 4 | 2.5L (4D5) diesel engine |
| | | 6 | 3.0L (6B3) petrol engine |
| 4 | Vehicle type | W | Station wagon |
| 5 | Body style | G | Wide fender |
| 6 | Transmission type | N | 5M/T |
| | | Y | 5A/T |
| 7 | Trim level (Price class) | M | M-line |
| | | P | P-line |
| | | U | U-line |
| 8 | Engine specification | Y | MIVEC (SOHC) |
| | | Z | Common rail (Intercooled turbocharger) |
| 9 | Steering wheel location | L | Left hand |
| 10 | Destination | AZ | Vehicles for Russia (PCMA-Rus manufactured vehicles) |

**VEHICLE IDENTIFICATION NUMBER
(CHASSIS NUMBER)**

M1001005603506

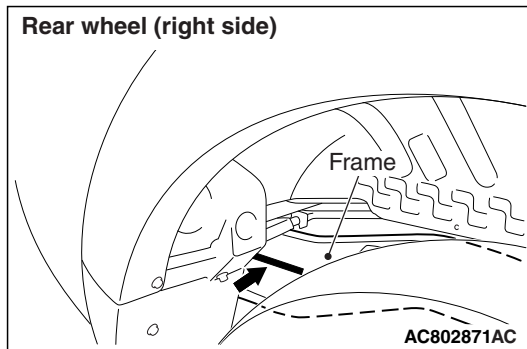

The vehicle identification number (chassis number) is stamped on the right side wall of the frame near the rear wheel.

CODE CHART

Λ Z 8 T X Y K H 4 W D M 9 0 0 0 0 1 Λ

1 2 3 4 5 6 7 8 9

ACD01899AB

| No. | Item | Content | |
|-----|-------------------------------------|------------------|-------------------------------------|
| 1 | World Manufacturer Identifier (WMI) | Z8T | PCMA-Rus |
| 2 | Body type | X | 4-door with hatchback-type tailgate |
| 3 | Transmission | N | 5M/T |
| | | Y | 5A/T |
| 4 | Car line and development order | KH | PAJERO SPORT – 4WD |
| 5 | Engine | 4 | 2.5L diesel engine |
| | | 6 | 3.0L petrol engine |
| 6 | Vehicle type | W | Station wagon |
| 7 | Model year | D | 2013 |
| 8 | Assembly plant | M | Kaluga (PCMA-Rus) |
| 9 | Serial number | 900001 to 940000 | |

CERTIFICATION LABEL

M1001017300406

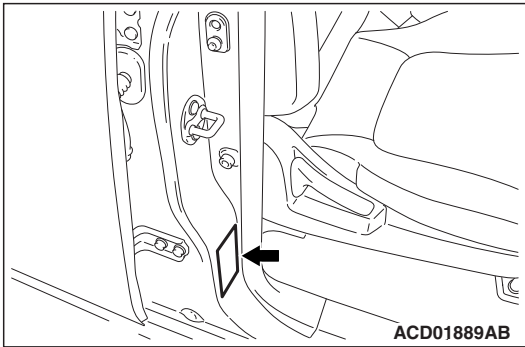

The certification label is attached to the centre pillar of the right side.

CODE CHART

MODEL: 1

ENGINE: 2 EXT: 3

TRANS: 4

AXLE: 5

COLOR: 6

INT: 7

OPT: 8

000 "ПСМА Рус"

9

10

11 k g

12 k g

1- 13 k g

2- 14 k g

ACD01892AB

| No. | Content |
|-----|--------------------------|
| 1 | Model code |
| 2 | Engine model code |
| 3 | Exterior code |
| 4 | Transmission model code |
| 5 | Rear axle gear ratio |
| 6 | Body colour code |
| 7 | Interior code |
| 8 | Option code |
| 9 | Approval number |
| 10 | Chassis number |
| 11 | Gross vehicle weight |
| 12 | Gross combination weight |
| 13 | Axle weight rating-front |
| 14 | Axle weight rating-rear |

GENERAL DATA AND SPECIFICATIONS

GENERAL DATA AND SPECIFICATIONS

M1001000908228

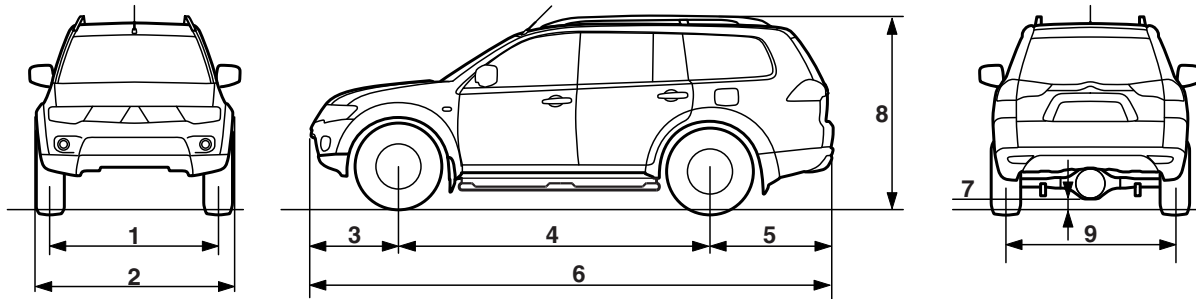

ACD02041AB

| Item | | | KH4W | |
|----------------------|--------------------------------|---|--|--|
| | | | GNMZLAZ | GYPZLAZ |
| Vehicle dimension mm | Front track | 1 | 1,520 | 1,520 |
| | Overall width | 2 | 1,815 | 1,815 |
| | Front overhang | 3 | 795 | 795 |
| | Wheel base | 4 | 2,800 | 2,800 |
| | Rear overhang | 5 | 1,100 | 1,100 |
| | Overall length | 6 | 4,695 | 4,695 |
| | Ground clearance (unladen) | 7 | 215 | 215 |
| | Overall height (unladen) | 8 | 1,840 | 1,840 |
| | Rear track | 9 | 1,515 | 1,515 |
| Vehicle weight kg | Kerb weight | | 2,045 | 2,070 |
| | Gross vehicle weight | | 2,710 | 2,710 |
| | Gross axle weight rating-front | | 1,260 | 1,260 |
| | Gross axle weight rating-rear | | 1,600 | 1,600 |
| | Gross combination weight | | 5,210 | 5,210 |
| Seating capacity | | | 5 | 5 |
| Engine | Model code | | 4D56 | 4D56 |
| | Type | | DOHC High-power diesel Intercooled, Turbocharger | DOHC High-power diesel Intercooled, Turbocharger |
| | Total displacement mL | | 2,477 | 2,477 |
| | Max. output <EEC> kW/r/min | | 131/4,000 | 131/4,000 |
| | Max. torque <EEC> N·m/r/min | | 400/2,000 - 2,850 | 350/1,800 - 3,500 |
| Fuel system | Fuel supply system | | Electrical fuel injection | Electrical fuel injection |
| Transmission | Model code | | V5MB1 | V5A5A |
| | Type | | Super select 4WD, 5M/T | Super select 4WD, 5A/T |
| Turning radius m | Body | | 5.9 | 5.9 |
| | Wheel | | 5.6 | 5.6 |

| Item | | | KH4W | |
|----------------------|--------------------------------|---|--|--|
| | | | GYUZLAZ | GYMZLAZ |
| Vehicle dimension mm | Front track | 1 | 1,520 | 1,520 |
| | Overall width | 2 | 1,815 | 1,815 |
| | Front overhang | 3 | 795 | 795 |
| | Wheel base | 4 | 2,800 | 2,800 |
| | Rear overhang | 5 | 1,100 | 1,100 |
| | Overall length | 6 | 4,695 | 4,695 |
| | Ground clearance (unladen) | 7 | 215 | 215 |
| | Overall height (unladen) | 8 | 1,840 | 1,840 |
| | Rear track | 9 | 1,515 | 1,515 |
| Vehicle weight kg | Kerb weight | | 2,070 | 2,040 |
| | Gross vehicle weight | | 2,710 | 2,710 |
| | Gross axle weight rating-front | | 1,260 | 1,260 |
| | Gross axle weight rating-rear | | 1,600 | 1,600 |
| | Gross combination weight | | 5,210 | 5,210 |
| Seating capacity | | | 5 | 5 |
| Engine | Model code | | 4D56 | 4D56 |
| | Type | | DOHC High-power diesel Intercooled, Turbocharger | DOHC High-power diesel Intercooled, Turbocharger |
| | Total displacement mL | | 2,477 | 2,477 |
| | Max. output <EEC> kW/r/min | | 131/4,000 | 131/4,000 |
| | Max. torque <EEC> N·m/r/min | | 350/1,800 - 3,500 | 350/1,800 - 3,500 |
| Fuel system | Fuel supply system | | Electrical fuel injection | Electrical fuel injection |
| Transmission | Model code | | V5A5A | V5A5A |
| | Type | | Super select 4WD, 5A/T | Super select 4WD, 5A/T |
| Turning radius m | Body | | 5.9 | 5.9 |
| | Wheel | | 5.6 | 5.6 |

| Item | | | KH6W | |
|----------------------|--------------------------------|---|--------------------------|--------------------------|
| | | | GYPYLAZ | GYUYLAZ |
| Vehicle dimension mm | Front track | 1 | 1,520 | 1,520 |
| | Overall width | 2 | 1,815 | 1,815 |
| | Front overhang | 3 | 795 | 795 |
| | Wheel base | 4 | 2,800 | 2,800 |
| | Rear overhang | 5 | 1,100 | 1,100 |
| | Overall length | 6 | 4,695 | 4,695 |
| | Ground clearance (unladen) | 7 | 215 | 215 |
| | Overall height (unladen) | 8 | 1,840 | 1,840 |
| | Rear track | 9 | 1,515 | 1,515 |
| Vehicle weight kg | Kerb weight | | 1,980 | 1,980 |
| | Gross vehicle weight | | 2,600 | 2,600 |
| | Gross axle weight rating-front | | 1,260 | 1,260 |
| | Gross axle weight rating-rear | | 1,600 | 1,600 |
| | Gross combination weight | | 5,100 | 5,100 |
| Seating capacity | | | 5 | 5 |
| Engine | Model code | | 6B31 | 6B31 |
| | Type | | SOHC MIVEC petrol engine | SOHC MIVEC petrol engine |
| | Total displacement mL | | 2,998 | 2,998 |
| | Max. output <EEC> kW/r/min | | 163/6,250 | 163/6,250 |
| | Max. torque <EEC> N·m/r/min | | 281/4,000 | 281/4,000 |
| Fuel system | Fuel supply system | | MPI | MPI |
| Transmission | Model code | | V5A5A | V5A5A |
| | Type | | Super select 4WD, 5A/T | Super select 4WD, 5A/T |
| Turning radius m | Body | | 5.9 | 5.9 |
| | Wheel | | 5.6 | 5.6 |

| Item | | | KH6W |
|----------------------|--------------------------------|---|--------------------------|
| | | | GYMYLAZ |
| Vehicle dimension mm | Front track | 1 | 1,520 |
| | Overall width | 2 | 1,815 |
| | Front overhang | 3 | 795 |
| | Wheel base | 4 | 2,800 |
| | Rear overhang | 5 | 1,100 |
| | Overall length | 6 | 4,695 |
| | Ground clearance (unladen) | 7 | 215 |
| | Overall height (unladen) | 8 | 1,840 |
| | Rear track | 9 | 1,515 |
| Vehicle weight kg | Kerb weight | | 1,960 |
| | Gross vehicle weight | | 2,600 |
| | Gross axle weight rating-front | | 1,260 |
| | Gross axle weight rating-rear | | 1,600 |
| | Gross combination weight | | 5,100 |
| Seating capacity | | | 5 |
| Engine | Model code | | 6B31 |
| | Type | | SOHC MIVEC petrol engine |
| | Total displacement mL | | 2,998 |
| | Max. output <EEC> kW/r/min | | 163/6,250 |
| | Max. torque <EEC> N·m/r/min | | 281/4,000 |
| Fuel system | Fuel supply system | | MPI |
| Transmission | Model code | | V5A5A |
| | Type | | Super select 4WD, 5A/T |
| Turning radius m | Body | | 5.9 |
| | Wheel | | 5.6 |

GROUP 12

ENGINE
LUBRICATION

CONTENTS

| | | | |
|---------------------------|------|-------------------------------|------|
| GENERAL INFORMATION | 12-2 | ON-VEHICLE SERVICE | 12-2 |
| | | ENGINE OIL CHANGE <6B3> | 12-2 |

GENERAL INFORMATION

M1121000101952

OUTLINE OF CHANGE

<6B3>

Due to the change of engine oil specification, the service procedure has been established. The other service procedures are the same as before.

ON-VEHICLE SERVICE

ENGINE OIL CHANGE <6B3>

M1121001003794

The service procedures other than below are the same as before.

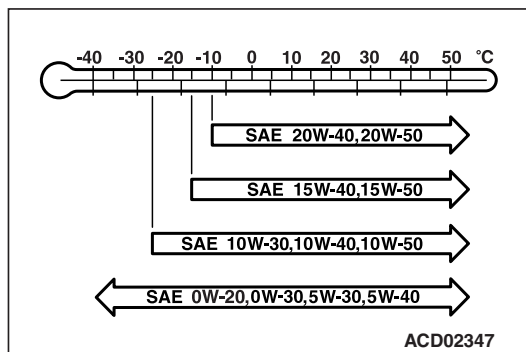

Refill with specified engine oil.

NOTE: Select engine oil of the proper SAE viscosity number according to the atmospheric temperature.

NOTE: SAE 0W-20, 0W-30, 5W-30, and 5W-40 engine oils can only be used if they meet ACEA A3/B3, A3/B4 or A5/B5 and API SG (or higher) specifications.

GROUP 51

EXTERIOR

CONTENTS

| | | | |
|----------------------------------|------|--------------------------------|------|
| GENERAL INFORMATION | 51-2 | RADIATOR GRILLE | 51-4 |
| FRONT BUMPER ASSEMBLY | 51-2 | ADHESIVE | 51-4 |
| FRONT BUMPER ASSEMBLY | 51-2 | REMOVAL AND INSTALLATION | 51-5 |
| REMOVAL AND INSTALLATION | 51-2 | HEADLAMP WASHER | 51-6 |
| DISASSEMBLY AND REASSEMBLY | 51-3 | REMOVAL AND INSTALLATION | 51-6 |

GENERAL INFORMATION

M1511000102833

OUTLINE OF CHANGE

- Due to the change of front bumper assembly, service procedures of the front bumper assembly, radiator grille and headlamp washer hose have been established.

FRONT BUMPER ASSEMBLY

FRONT BUMPER ASSEMBLY

REMOVAL AND INSTALLATION

M1511001402536

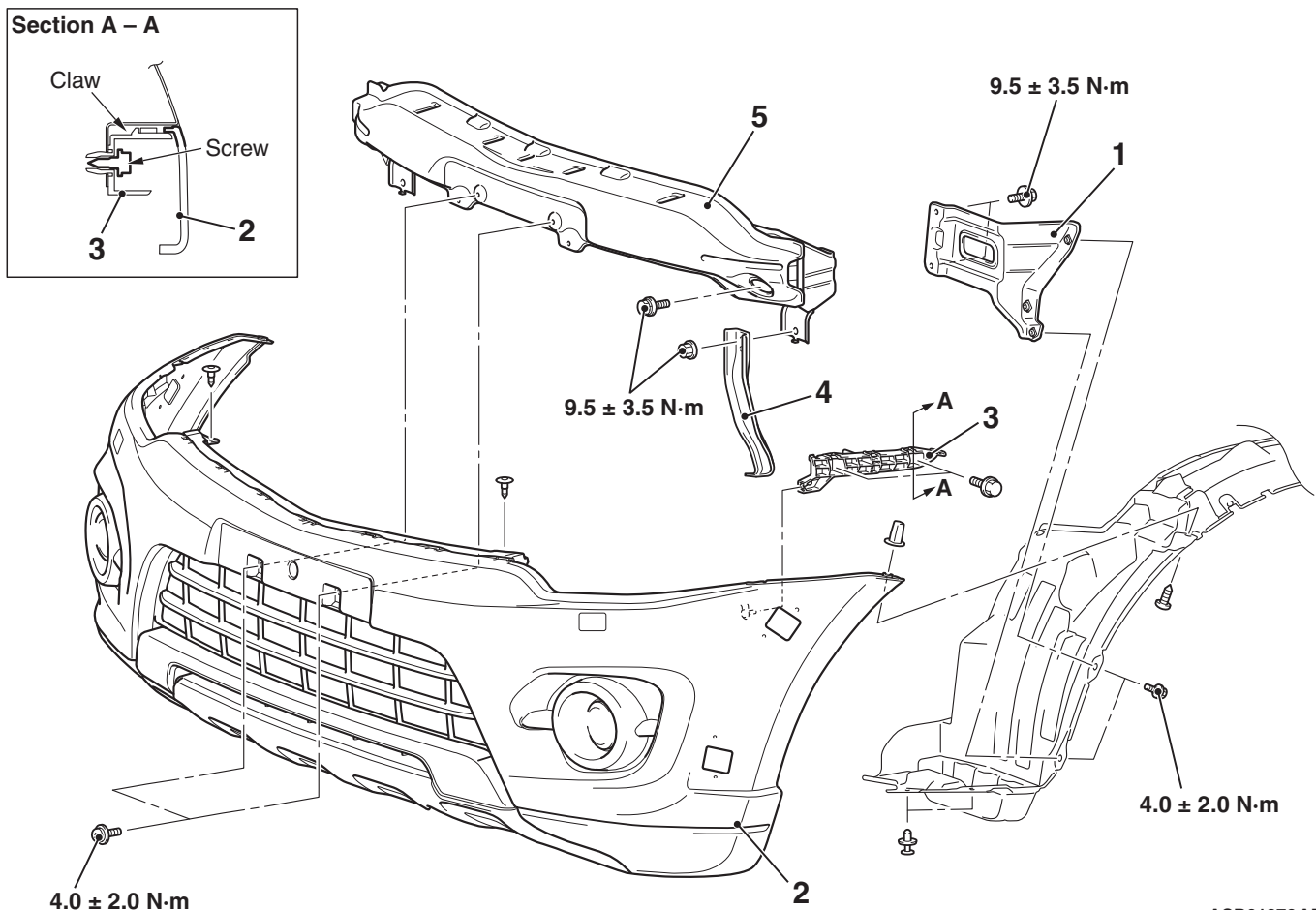

ACD01876 AB

Removal steps

- Radiator grille (Refer to P.51-5.)
- Front overfender
- 1. Front bumper side stay
- Fog lamp connector connection

Removal steps (Continued)

2. Front bumper assembly
3. Front bumper support bracket
4. Front bumper stay
5. Front bumper reinforcement

DISASSEMBLY AND REASSEMBLY

M1511001602756

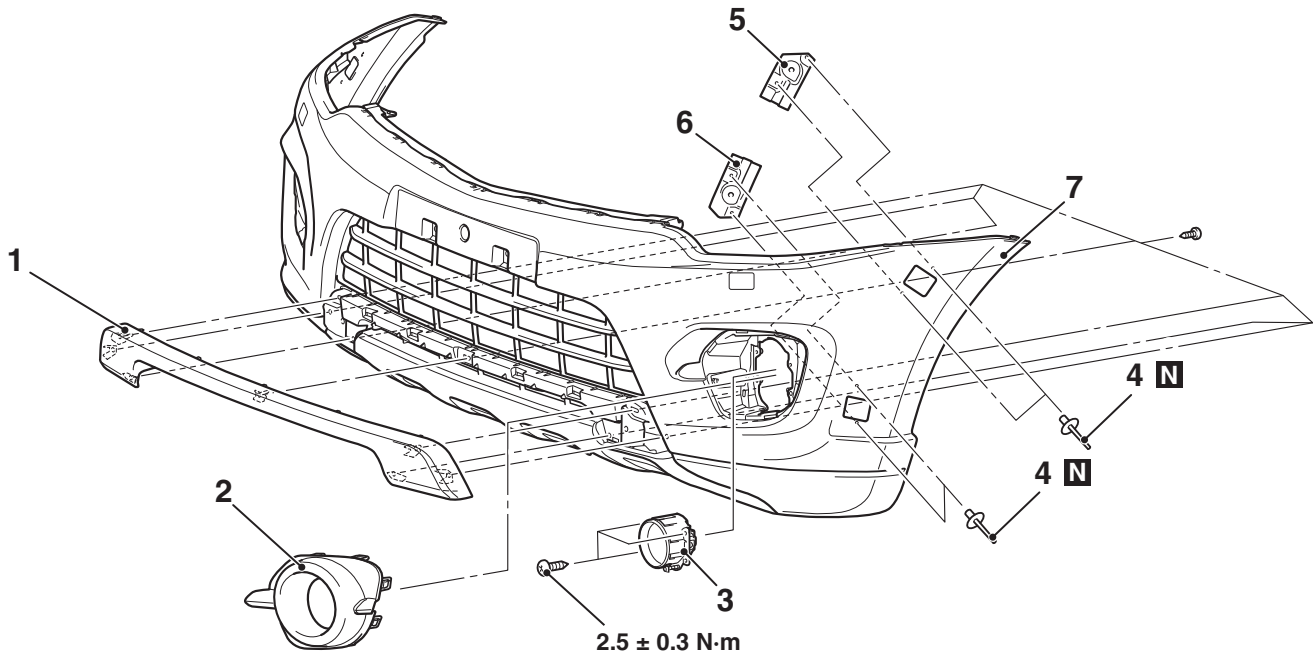

ACD01877AB

Disassembly steps

1. Guard bar
2. Front fog lamp bezel
3. Front fog lamp
4. Rivets
5. Front bumper side bracket upper
6. Front bumper side bracket lower
7. Front bumper face

<<A>> >>A<<

DISASSEMBLY SERVICE POINT <<A>> RIVETS REMOVAL

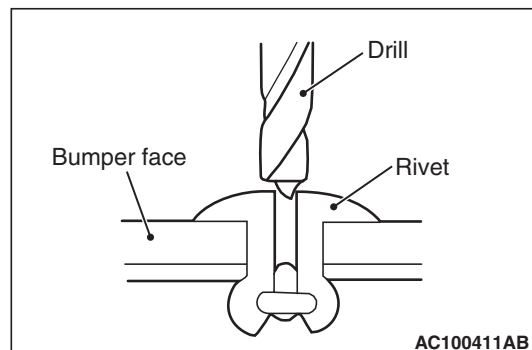

Use a drill (ϕ 4.0 mm) to make a hole in the rivet to break it, and remove the rivet.

REASSEMBLY SERVICE POINT
>>A<< RIVETS INSTALLATION

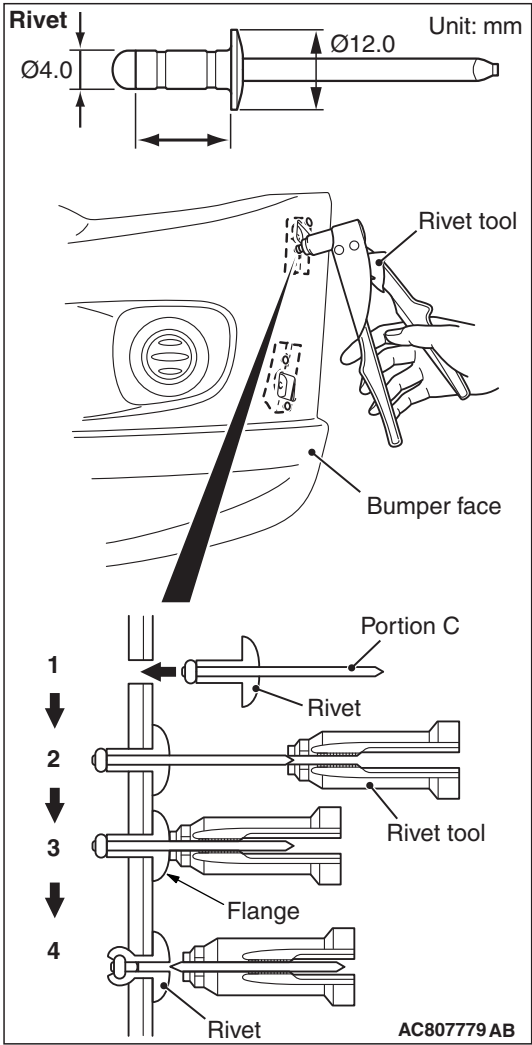

- 1. Insert rivet into the front bumper side bracket and front bumper face.
- 2. Place the rivet tool over portion C of rivet.
- 3. While pushing the flange surface of the rivet onto parts to be fixed with the rivet tool, press the handle of the tool.
- 4. Thin part of portion C of the rivet will cut off and the rivet is fixed in position.

Use a rivet tool shown in the illustration to connect the parts with rivets by the following procedures.

RADIATOR GRILLE

ADHESIVE

M1511000502916

| Application | Specified adhesive |
|--------------------------|---|
| Front three-diamond mark | Double-sided tape: Generic products, 1.2 mm thickness |

REMOVAL AND INSTALLATION

M1511002901423

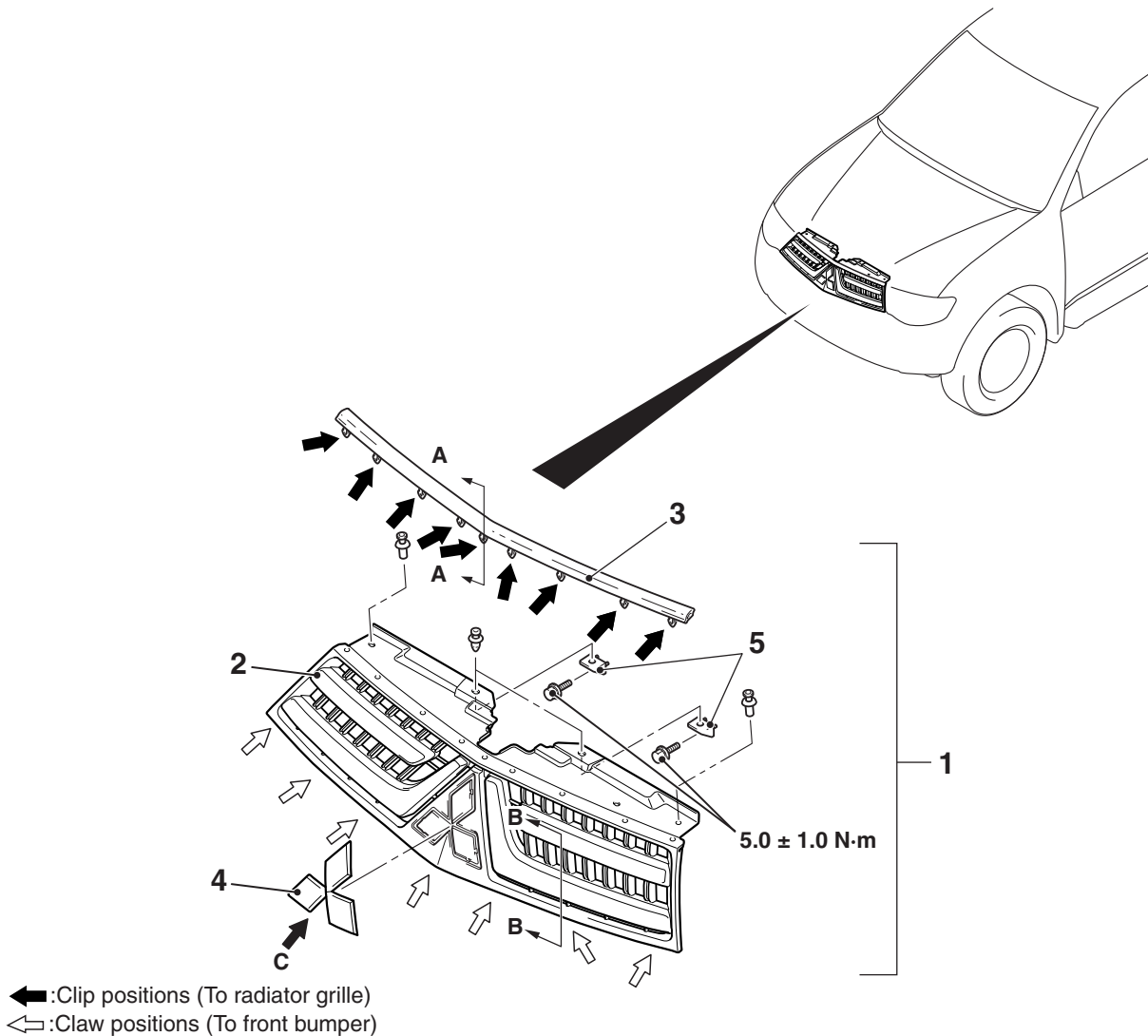
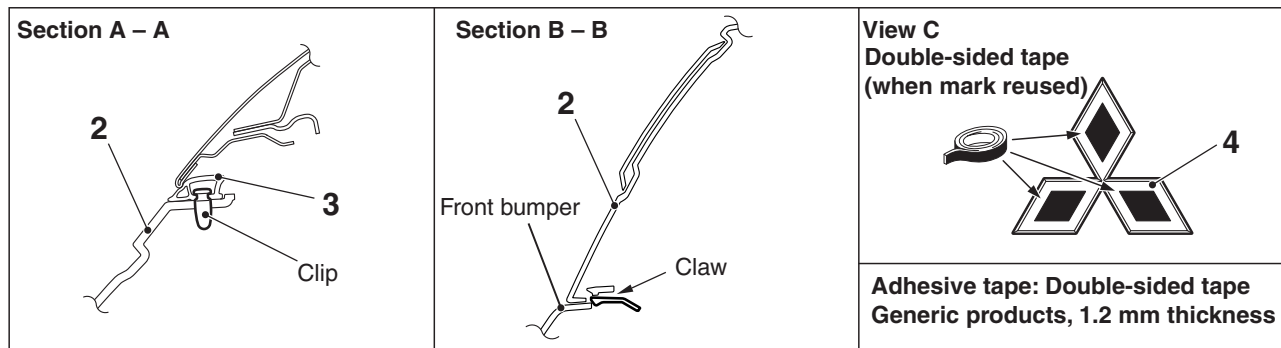

ACC07840 AB

Removal steps

1. Radiator grille assembly
2. Radiator grille
3. Radiator grille weatherstrip

Removal steps (Continued)

4. Front three-diamond mark
5. Bracket

HEADLAMP WASHER

REMOVAL AND INSTALLATION

M1511009700472

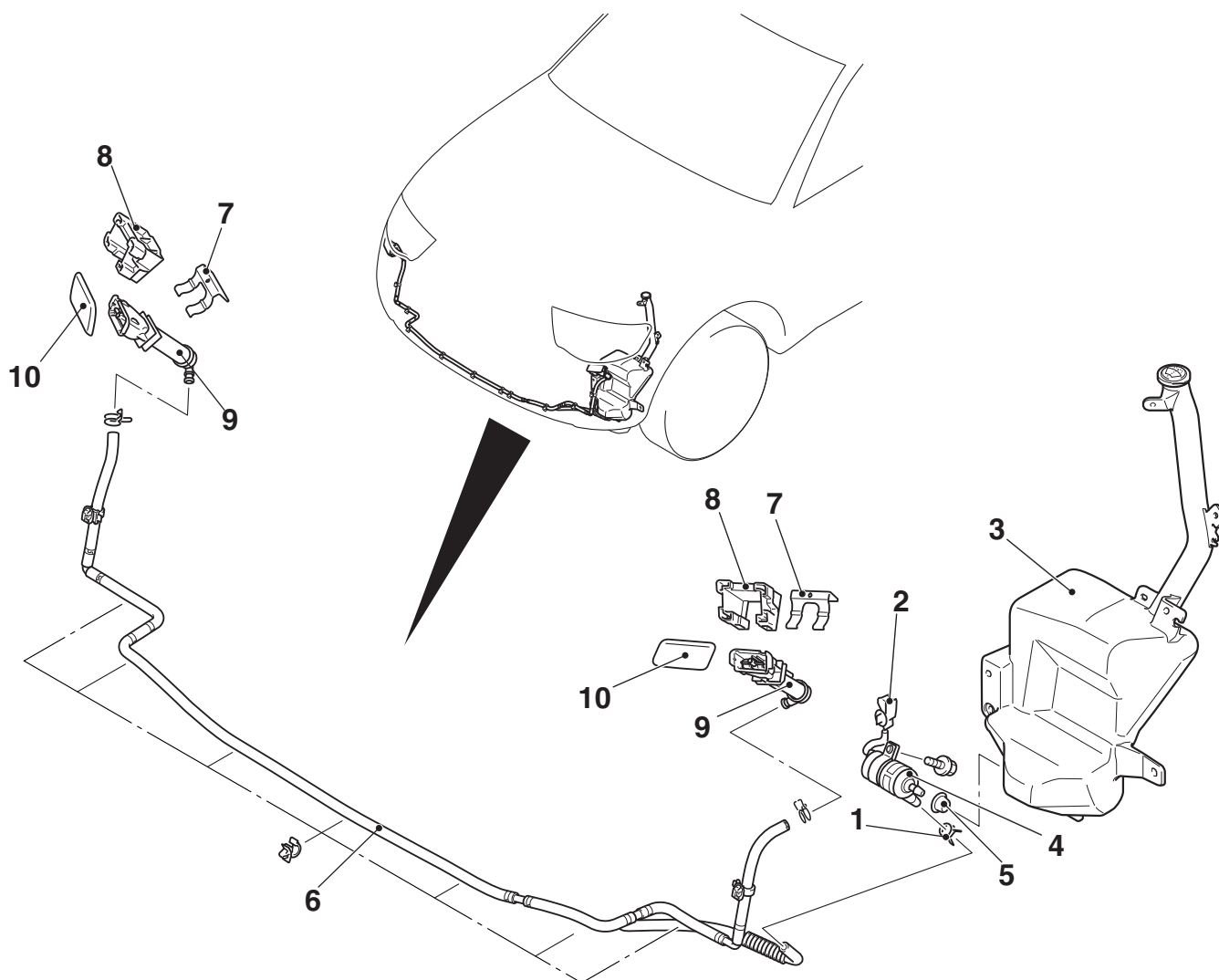

ACD00015AB

Removal steps

- Front bumper (Refer to [P.51-2](#))
- Washer fluid draining
- 1. Headlamp washer hose connection (headlamp washer motor side)
- 2. Headlamp washer motor connector connection
- 3. Windshield washer tank

Removal steps (Continued)

- 4. Headlamp washer motor
- 5. Packing
- 6. Headlamp washer hose
- 7. Headlamp washer clamp
- 8. Headlamp washer collar
- 9. Headlamp washer actuator assembly
- 10. Headlamp washer cover

GROUP 54A

CHASSIS
ELECTRICAL

CONTENTS

| | | | |
|---------------------------|-------|-----------------------------|-------|
| FRONT FOG LAMP | 54A-2 | REAR COMBINATION LAMP | 54A-2 |
| GENERAL INFORMATION | 54A-2 | GENERAL INFORMATION | 54A-2 |

FRONT FOG LAMP

GENERAL INFORMATION

M1540402500301

OUTLINE OF CHANGE

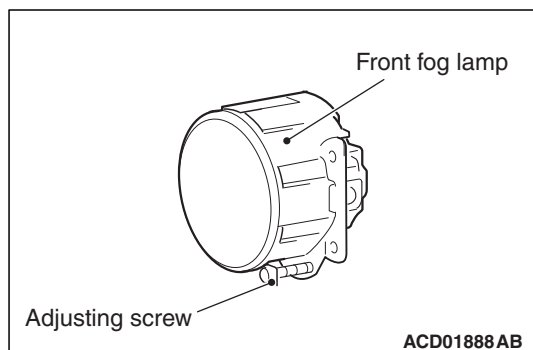

The location of the front fog lamp aiming adjusting screw has been changed from upper side to lower side. The service procedures are the same as before.

REAR COMBINATION LAMP

GENERAL INFORMATION

M1541402800123

OUTLINE OF CHANGE

The rear turn-signal lamp bulb type has been changed from P21W to PY21W. The service procedures are the same as before.