

PURPOSE : INFORMATION	ISSUE NO. : MSB-08E35-004	DATE : 2008-07-05
SUBJECT : REPAIR KIT GREASE	<div> <div>&lt;MODEL&gt;</div> <div>(EUR/RUSSIA)</div> <div>OUTLANDER</div> <div>(GS45X)(CW0W)</div> </div> <div> <div>&lt;M/Y&gt;</div> <div>07-08</div> </div>	
GROUP : SERVICE BRAKE		

## 1. Description:

Application of the repair kit grease to the brake pad assemblies is established and, accordingly, the application points of the grease are specified. In addition, the descriptions of the repair kit grease to be applied to the shim kits have been omitted in the applicable Workshop Manuals. This Service Bulletin contains the added descriptions.

## 2. Applicable Manuals:

### <EUR>

Manual	Pub. No.	Title (Info-ID)	Attachment
2007 OUTLANDER Workshop Manual	CGXE07E1-CD (English) CGXS07E1-CD (Spanish) CGXF07E1-CD (French) CGXG07E1-CD (German)	Lubricants (M351-00-040-83800-01)	Attachment 1
		Front Disc Brake Assembly Disassembly and Reassembly (M351-00-621-07300-01)	Attachment 2
2008 OUTLANDER Workshop Manual	CGXE08E2-CD (English) CGXF08E2-CD (French) CGXG08E2-CD (German) CGXS08E2-CD (Spanish)	Lubricants (M351-00-040-83800-01)	Attachment 1
		Front Disc Brake Assembly Disassembly and Reassembly (M351-00-621-27700-01)	Attachment 3-4

### <RUSSIA>

Underneath Manual	Underneath Pub. No.	Title (Info-ID)	Attachment
2007 OUTLANDER Workshop Manual	N/A	Lubricants (M351-00-040-83800-01)	Attachment 1
		Front Disc Brake Assembly Disassembly and Reassembly (M351-00-621-07300-01)	Attachment 2
2008 OUTLANDER Workshop Manual	N/A	Lubricants (M351-00-040-83800-01)	Attachment 1
		Front Disc Brake Assembly Disassembly and Reassembly (M351-00-621-27700-01)	Attachment 3-4

## 3. Effective Date:

From late May 2008 (application of grease to the brake pad assemblies)

4. Details:

Attachment 1

**BASIC BRAKE SYSTEM  
LUBRICANTS**

**LUBRICANTS**

M1351000400838

Item		Specified lubricant	Quantity
Brake fluid		DOT3 or DOT4	As required
Front disc brake	Guide pin, lock pin, pin boot, bushing	Repair kit grease (solid orange)	
	Boot ring, piston boot	Repair kit grease (translucent red)	
	Piston, caliper body	DOT3 or DOT4	
Rear disc brake	Guide pin, lock pin, pin boot, bushing	Repair kit grease (solid orange)	As required <Added>
	Boot ring, piston boot	Repair kit grease (translucent red)	
	Piston, caliper body	DOT3 or DOT4	

<Added>

	Shim, brake pad assembly	Repair kit grease (Yellow)	Approx. 0.2 g
	Brake pad assembly, clip	Repair kit grease (Copper), Molykote 7439 or equivalent	

# BASIC BRAKE SYSTEM FRONT DISC BRAKE ASSEMBLY

## DISASSEMBLY AND REASSEMBLY

M1351006201073

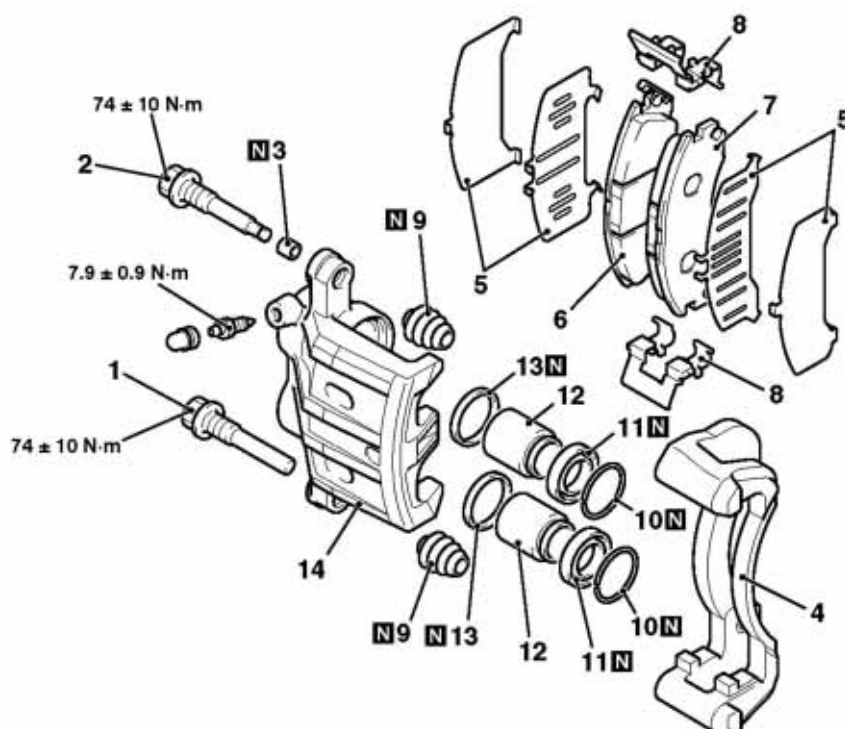

AC613303AB

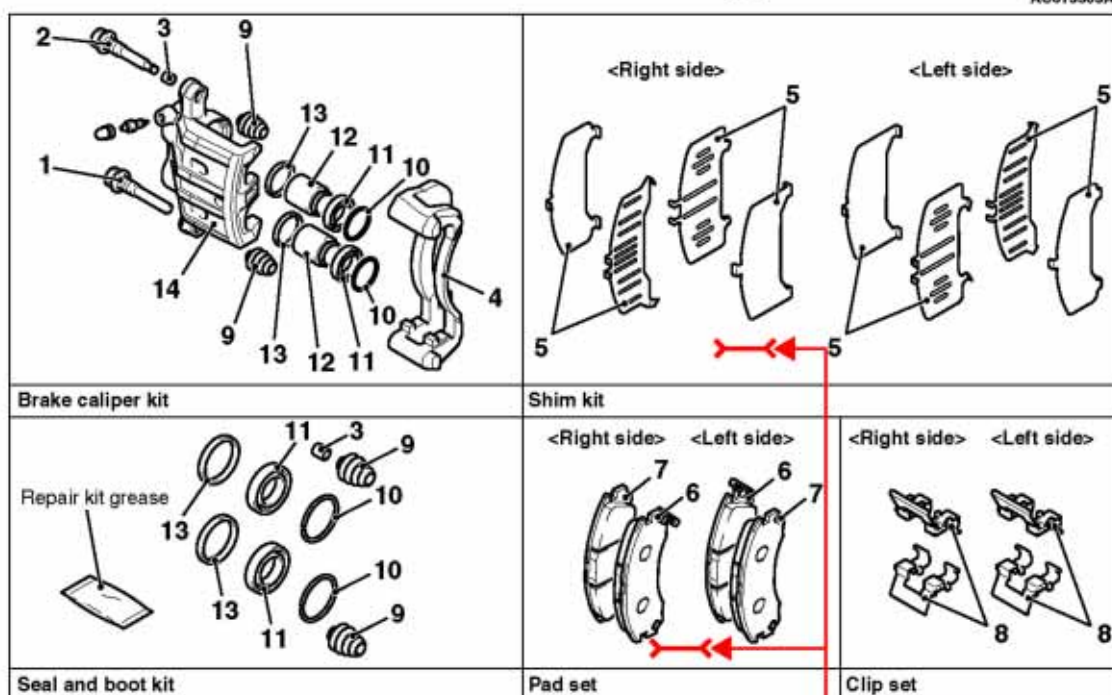

Repair kit grease

&lt;Added&gt;

# **BASIC BRAKE SYSTEM FRONT DISC BRAKE ASSEMBLY**

## **Disassembly steps**

1. Lock pin
2. Guide pin
3. Bushing
4. Caliper support  
(including pad, clip, and shim)
5. Shim
6. Pad & wear indicator assembly
7. Pad assembly
8. Clip
9. Pin boot
10. Boot ring
11. Piston boot

&lt;&lt;A&gt;&gt;

## **Disassembly steps (Continued)**

12. Piston
13. Piston seal
14. Caliper body

&lt;&lt;A&gt;&gt;

&lt;&lt;B&gt;&gt;

## **NOTE:**

- As for the pad set, the brake pads for both the right wheels and the left wheels have the wear indicator.
- Install the pad & wear indicator assembly to the inner side of the brake disc, making sure that the wear indicator is located on the top.

## **LUBRICATION POINTS**

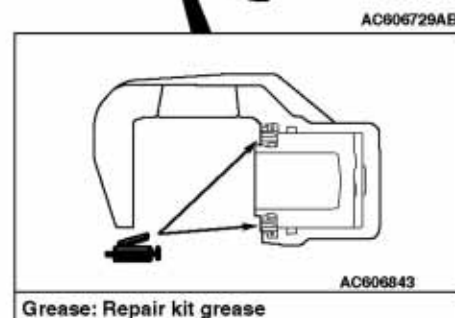
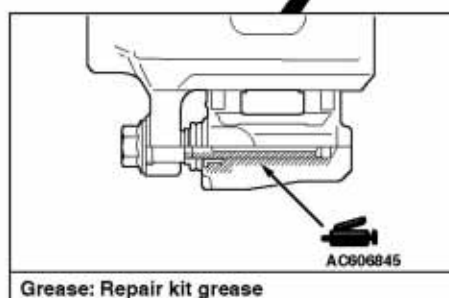
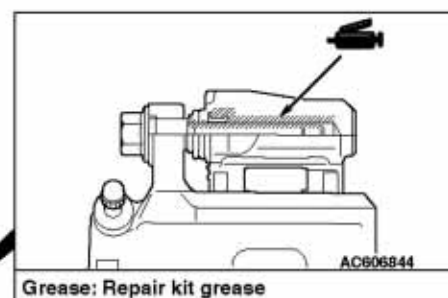
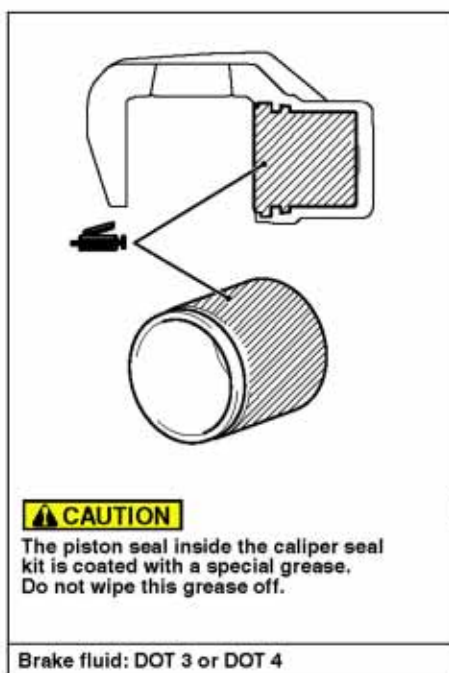

➡ Add Attachment 4. ⚡

# BASIC BRAKE SYSTEM FRONT DISC BRAKE ASSEMBLY

## DISASSEMBLY AND REASSEMBLY

M1351006201277

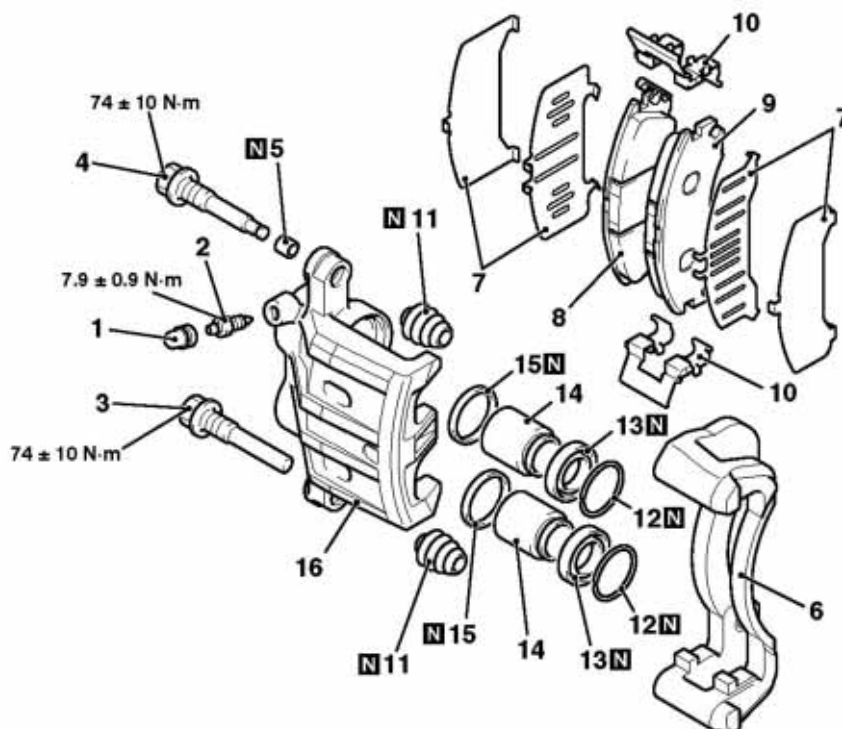

AC613303AC

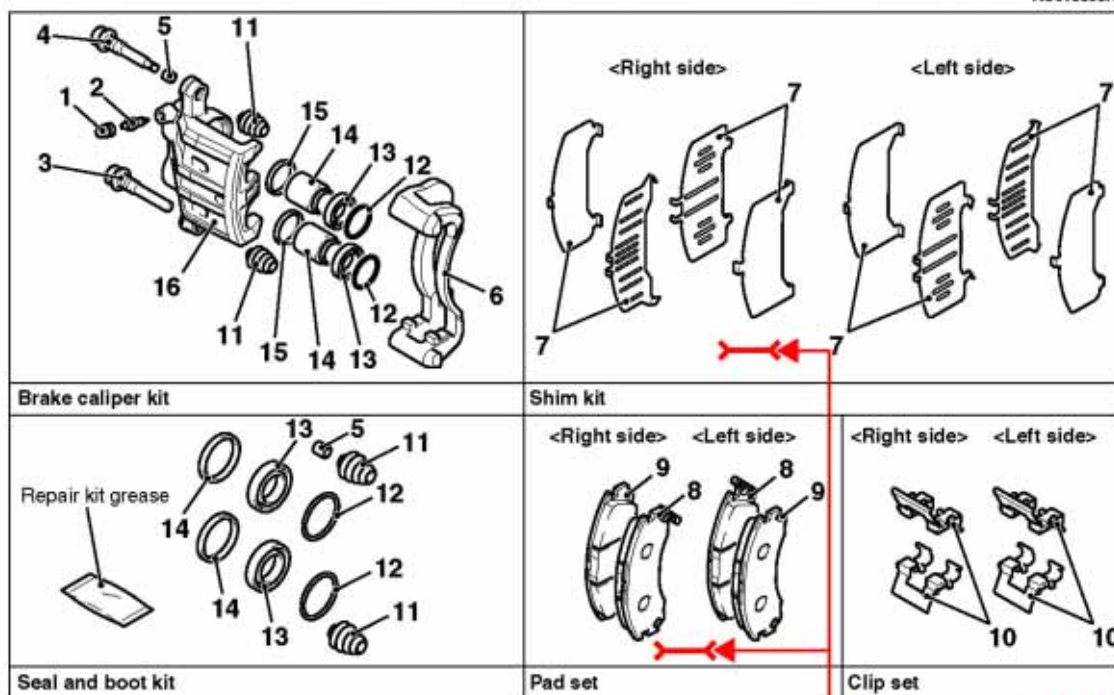



## BASIC BRAKE SYSTEM FRONT DISC BRAKE ASSEMBLY

### Disassembly steps

1. Bleeder cap
2. Bleeder
3. Guide pin
4. Lock pin
5. Bushing
6. Caliper support  
(including pad, clip, and shim)
7. Shim
8. Pad & wear indicator assembly
9. Pad assembly
10. Clip
11. Pin boot
12. Boot ring

&lt;&lt;A&gt;&gt;

&lt;&lt;A&gt;&gt;

&lt;&lt;B&gt;&gt;

### Disassembly steps (Continued)

13. Piston boot
14. Piston
15. Piston seal
16. Caliper body

### NOTE:

- As for the pad set, the brake pads for both the right wheels and the left wheels have the wear indicator.
- Install the pad & wear indicator assembly to the inner side of the brake disc, making sure that the wear indicator is located on the top.

### LUBRICATION POINTS

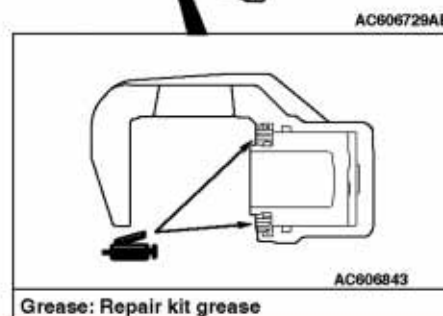
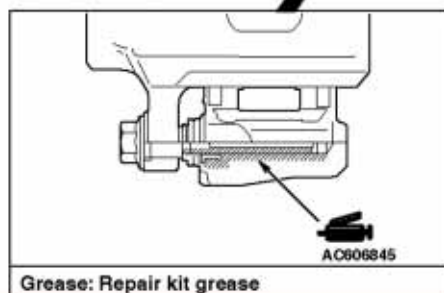
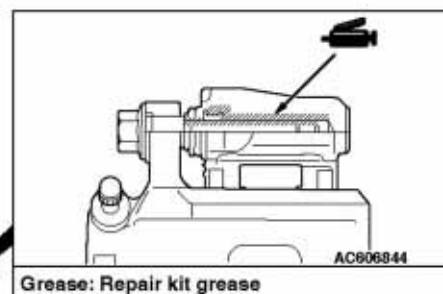
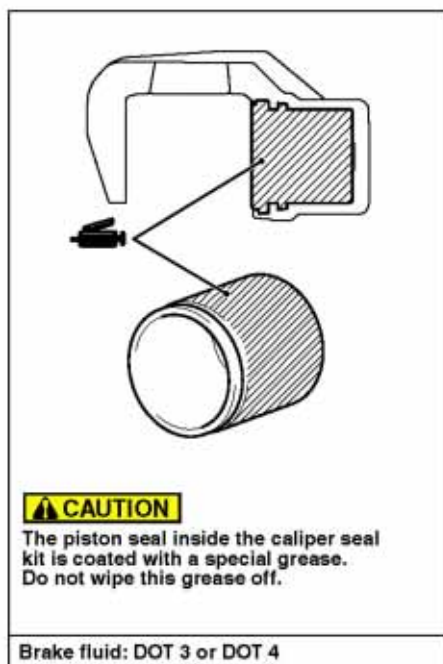

➡ Add Attachment 4. ⬅

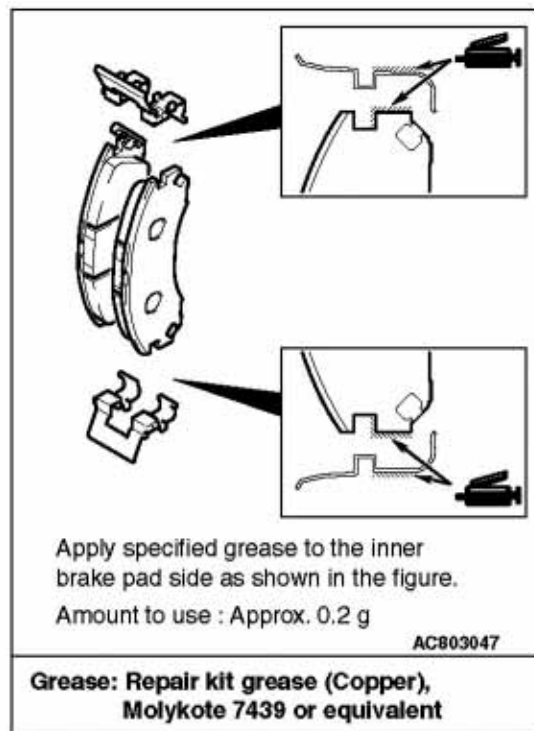
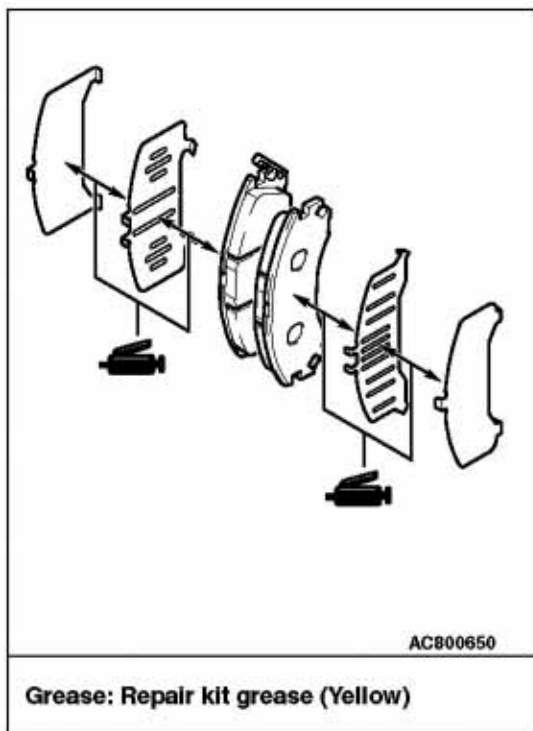

AC803048